



Roll Call Number

Agenda Item Number

52

Date June 23, 2014

An Ordinance entitled, "AN ORDINANCE to amend the Municipal Code of the City of Des Moines, Iowa, 2000, adopted by Ordinance No. 13,827, passed June 5, 2000, as heretofore amended, by amending Sections 114-1330, 114-2234, 114-2600, 114-3466, 114-3710, 114-3756.06, 114-3862, 114-3926 and 114-3933.03, and by adding and enacting new Sections 114-3709.01, 114-3709.02 and 114-3931.01, relating to traffic and vehicle regulations",

presented.

Moved by _____ that this ordinance be considered and given first vote for passage.

FORM APPROVED:

(First of three required readings)

Signature of Carol J. Moser

Carol J. Moser
Deputy City Attorney

(Council Communication No. 14-290)

Table with 5 columns: COUNCIL ACTION, YEAS, NAYS, PASS, ABSENT. Rows include COWNIE, COLEMAN, GATTO, GRAY, HENSLEY, MAHAFFEY, MOORE, and TOTAL.

MOTION CARRIED APPROVED

Mayor

CERTIFICATE

I, DIANE RAUH, City Clerk of said City hereby certify that at a meeting of the City Council of said City of Des Moines, held on the above date, among other proceedings the above was adopted.

IN WITNESS WHEREOF, I have hereunto set my hand and affixed my seal the day and year first above written.

City Clerk

ORDINANCE NO. _____

AN ORDINANCE to amend the Municipal Code of the City of Des Moines, Iowa, 2000, adopted by Ordinance No. 13,827, passed June 5, 2000, as heretofore amended, by amending Sections 114-1330, 114-2234, 114-2600, 114-3466, 114-3710, 114-3756.06, 114-3862, 114-3926 and 114-3933.03, and by adding and enacting new Sections 114-3709.01, 114-3709.02 and 114-3931.01, relating to traffic and vehicle regulations.

Be It Ordained by the City Council of the City of Des Moines, Iowa:

Section 1. That the Municipal Code of the City of Des Moines, Iowa, 2000, adopted by Ordinance No. 13,827, passed June 5, 2000, as heretofore amended, is hereby amended by amending Sections 114-1330, 114-2234, 114-2600, 114-3466, 114-3710, 114-3756.06, 114-3862, 114-3926 and 114-3933.03, and by adding and enacting new Sections 114-3709.01, 114-3709.02 and 114-3931.01, relating to traffic and vehicle regulations, as follows:

Sec. 114-1330. Keosauqua Way.

Keosauqua Way, from Tenth Street to ~~Lynn~~ Nineteenth Street, 35 miles per hour.

Sec. 114-2234. Hull Avenue.

Hull Avenue, from the east line of Second Avenue to the west line of Cornell Street, stop.
Hull Avenue, from the east line of Cornell Street to the west line of Dixon Street, stop.
Hull Avenue, from the east line of Dixon Street to the west line of East Twenty-ninth Street, stop.
Hull Avenue, at East Thirty-fifth Street, stop.
Hull Avenue, at East Thirty-sixth Court, stop.

Sec. 114-2600. Southwest Second Street--Vine Street to Lally Street.

Southwest Second Street, on the west side, from Vine Street to a point 17 feet south thereof, no parking any time.
Southwest Second Street, on the east side, from Vine Street (eastbound) to a point 15 feet south thereof, no parking any time.
Southwest Second Street, on the west side, from a point 57 feet south of Vine Street to a point 60 feet south thereof, no parking any time.
Southwest Second Street, on the west side, from a point 139 feet south of Vine Street to a point 20 feet south thereof, no parking any time.

Southwest Second Street, on the west side, from a point 159 feet south of Vine Street to a point 58 feet south thereof, commercial loading zone.

Southwest Second Street, on the west side, from a point 257 feet south of Vine Street to Market Street, no parking any time.

Southwest Second Street, on the east side, from a point ~~80~~ 15 feet north of Market Street to a point 35 feet south of Market Street, no parking any time.

Southwest Second Street, on the east side, from a point 121 feet south of Market Street to West Martin Luther King Jr Parkway, no parking any time.

Southwest Second Street, on the west side, from Market Street to a point 54 feet south thereof, no parking any time.

Southwest Second Street, on the west side, from a point 100 feet south of Market Street to a point 50 feet south thereof, commercial loading zone.

Southwest Second Street, on the west side, from a point 150 feet south of Market Street to a point 27 feet south thereof, no parking any time.

Southwest Second Street, on the west side, from Martin Luther King Jr Parkway to as point 50 feet north thereof, no parking any time.

Southwest Second Street, on the west side, from Martin Luther King Jr Parkway to Southwest Third Street, no parking any time.

Southwest Second Street, on the east side, from Columbus Avenue to a point 50 feet north thereof, no parking any time.

Southwest Second Street, on the west side, from Livingston Avenue to Columbus Avenue, no parking any time.

Southwest Second Street, on the east side, from Park Avenue to Pleasant View Drive, no parking any time.

Southwest Second Street, on the west side, from Park Avenue to Thornton Avenue, no parking any time.

Southwest Second Street, on the west side, from Thornton Avenue to a point 40 feet south thereof, no parking any time.

Southwest Second Street, on the east side, from Thornton Avenue to Watrous Avenue, no parking any time.

Southwest Second Street, on the west side, from Philip Street to McKinley Avenue, no parking any time.

Southwest Second Street, on the west side, from Porter Avenue to Lally Street, no parking any time.

Southwest Second Street, on the east side, from Porter Avenue to a point 150 feet south thereof, school passenger loading and unloading, 7:00 a.m. to 5:00 p.m. school days.

Sec. 114-3466. Market Street--Southwest Water Street to Southwest Sixth Street.

Market Street, on the south side, from a point 135 feet west of Southwest Water Street to a point forty feet west thereof, loading zone.

Market Street, on the south side, from Southwest Second Street to a point 22 feet west thereof, no parking any time.

Market Street on the south side, from a point 135 feet west of Southwest Second Street to a point 55 feet west thereof, no parking any time.

Market Street, on the north side, from Southwest Second Street to a point 25 feet east thereof, no parking any time.

Market Street, on the north side, from a point 70 feet east of Southwest Second Street to a point 80 feet east thereof, no parking any time.

Market Street, on the north side, from a point 150 feet east of Southwest Second Street to a point 105 feet east thereof, passenger loading and unloading, ten minutes only.

Market Street, on the north side, from a point 255 feet east of Southwest Second Street to Southwest Water Street, no parking any time.

Market Street, on the north side, from Southwest ~~Water~~ Second Street to Southwest Third Street, no parking 7:00 a.m. to 6:00 p.m., Monday through Friday.

Market Street, on the south side, from Southwest Fourth Street, to a point 25 feet west thereof, no parking any time.

Market Street, on the north side, from Southwest Fourth Street, to a point 25 feet west thereof, no parking any time.

Market Street, on the south side, from Southwest Fifth Street to a point 25 feet east thereof, no parking any time.

Market Street, on the north side, from a point 165 feet west of Southwest Fourth Street to a point 40 feet west thereof, no parking any time.

Market Street, on the north side, from Southwest Fifth Street to a point 25 feet east thereof, no parking any time.

Sec. 114-3709.01. Vine Street (Eastbound)—Southwest Water Street to Southwest Second Street.

Vine Street (eastbound), on the north side, from Southwest Water Street to Southwest Second Street, no parking any time.

Vine Street (eastbound), on the south side, from Southwest Second Street to a point 75 feet east thereof, no parking any time.

Vine Street (eastbound), on the south side, from a point 75 feet east of Southwest Second Street to a point 125 feet east thereof, passenger loading and unloading, ten minutes only.

Vine Street (eastbound), on the south side, from a point 200 feet east of Southwest Second Street to Southwest Water Street, no parking any time.

Sec. 114-3709.02. Vine Street (Westbound)—Southwest Water Street to Southwest Second Street.

Vine Street (westbound), on the north side, from Southwest Second Street to a point 30 feet east thereof, no parking any time.

Vine Street (westbound), on the north side, from Southwest Water Street to a point 30 feet west thereof, no parking any time.

Vine Street (westbound), on the south side, from Southwest Water Street to Southwest Second Street, no parking any time.

Sec. 114-3710. Vine Street--~~Southwest Water~~ Second Street to Southwest Twelfth Street.

Vine Street, on both sides, from Southwest ~~Water~~ Second Street to Southwest Fifth Street, no parking any time.

Vine Street, on the south side, from Southwest Seventh Street to Southwest Ninth Street, no parking any time.

Sec. 114-3756.06. Southwest Water Street--Vine Street to Southeast First Street.

Southwest Water Street, on the west side, from ~~Market~~ Vine Street to a point 63 feet south ~~thereof~~ of Market Street, no parking any time.

Southwest Water Street, on the west side, from a point 183 feet south of Market Street to a point sixty feet south thereof, loading zone.

Southwest Water Street, on the west side, from a point ~~34~~ 243 feet ~~north of Elm Street to Elm Street~~ South of Market Street to West Martin Luther King Jr Parkway, no parking any time.

Southwest Water Street, on the west side, from a point ~~225~~ 200 feet south of ~~Elm Street~~ West Martin Luther King Jr Parkway to Southeast First Street, no parking any time.

Sec. 114-3862. Southwest Second Street--Vine Street to West Martin Luther King Jr Parkway.

Southwest Second Street, on the east side, from a point 15 feet south of Vine Street (eastbound) to a point ~~80~~ 15 feet north of Market Street, four-hour meters, 8:00 a.m. to 6:00 p.m.

Southwest Second Street, on the east side, from a point 35 feet south of Market Street to a point 86 feet south thereof, four hour meters, 8:00 a.m. to 6:00 p.m.

Southwest Second Street, on the west side, from a point 17 feet south of Vine Street to a point 40 feet south thereof, four-hour meters, 8:00 a.m. to 6:00 p.m.

Southwest Second Street, on the west side, from a point 117 feet south of Vine Street to a point 22 feet south thereof, four-hour meters, 8:00 a.m. to 6:00 p.m.

Southwest Second Street, on the west side, from a point 217 feet south of Vine Street to a point 40 feet south thereof, four-hour meters, 8:00 a.m. to 6:00 p.m.

Southwest Second Street, on the west side, from a point 54 feet south of Market Street to a point 46 feet south thereof, four-hour meters, 8:00 a.m. to 6:00 p.m.

Southwest Second Street, on the east side, from a point 100 feet north of West Martin Luther King Jr Parkway to a point 50 feet south thereof, four-hour meters, 8:00 a.m. to 6:00 p.m.

Sec. 114-3926. Market Street--Southwest Water Street to Southwest Third Street.

Market Street, on the south side, from Southwest Water Street to a point 135 feet west thereof, ten-hour meters, 8:00 a.m. to 6:00 p.m.

Market Street, on the south side, from a point 175 feet west of Southwest Water Street to Southwest Second Street, ten-hour meters, 8:00 a.m. to 6:00 p.m.

Market Street, on the south side, from a point 22 feet west of Southwest Second Street to a point 110 feet west thereof, ten-hour meters, 8:00 a.m. to 6:00 p.m.

Market Street, on the south side, from a point 187 feet west of Southwest Second Street to Southwest Third Street, ten-hour meters, 8:00 a.m. to 6:00 p.m.

Market Street, on the north side, from a point 25 feet east of Southwest Second Street to a point 45 feet east thereof, ten-hour meters, 8:00 a.m. to 6:00 p.m.

Sec. 114-3931.01. Vine Street (Westbound)—Southwest Water Street to Southwest Second Street.

Vine Street (westbound), on the north side, from a point 30 feet east of Southwest Second Street to a point 30 feet west of Southwest Water Street, four-hour meters, 8:00 a.m. to 6:00 p.m.

Sec. 114-3933.03. Southwest Water Street--Vine Street to West Martin Luther King Jr Parkway.

Southwest Water Street, ~~on both sides~~ on the east side, from Vine Street to Market Street, ten-hour meters, 8:00 a.m. to 6:00 p.m.

Southwest Water Street, on the west side, from a point 63 feet south of Market Street to a point 120 feet south thereof, four hour meters, 8:00 a.m. to 6:00 p.m.

Southwest Water Street, on the west side, from a point 243 feet south of Market Street to a point 31 feet north of Elm Street, four hour meters, 8:00 a.m. to 6:00 p.m.

Southwest Water Street, on the east side, from Market Street to a point 50 feet north of Elm Street, ten-hour meters, 8:00 a.m. to 6:00 p.m.

Section 2. This ordinance shall be in full force and effect from and after its passage and publication as provided by law.

FORM APPROVED:



Carol J. Moser
Deputy City Attorney

52B.

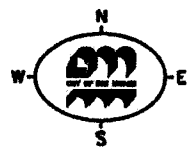

**Stop Sign Installation
at E 35th Street and Hull Avenue**

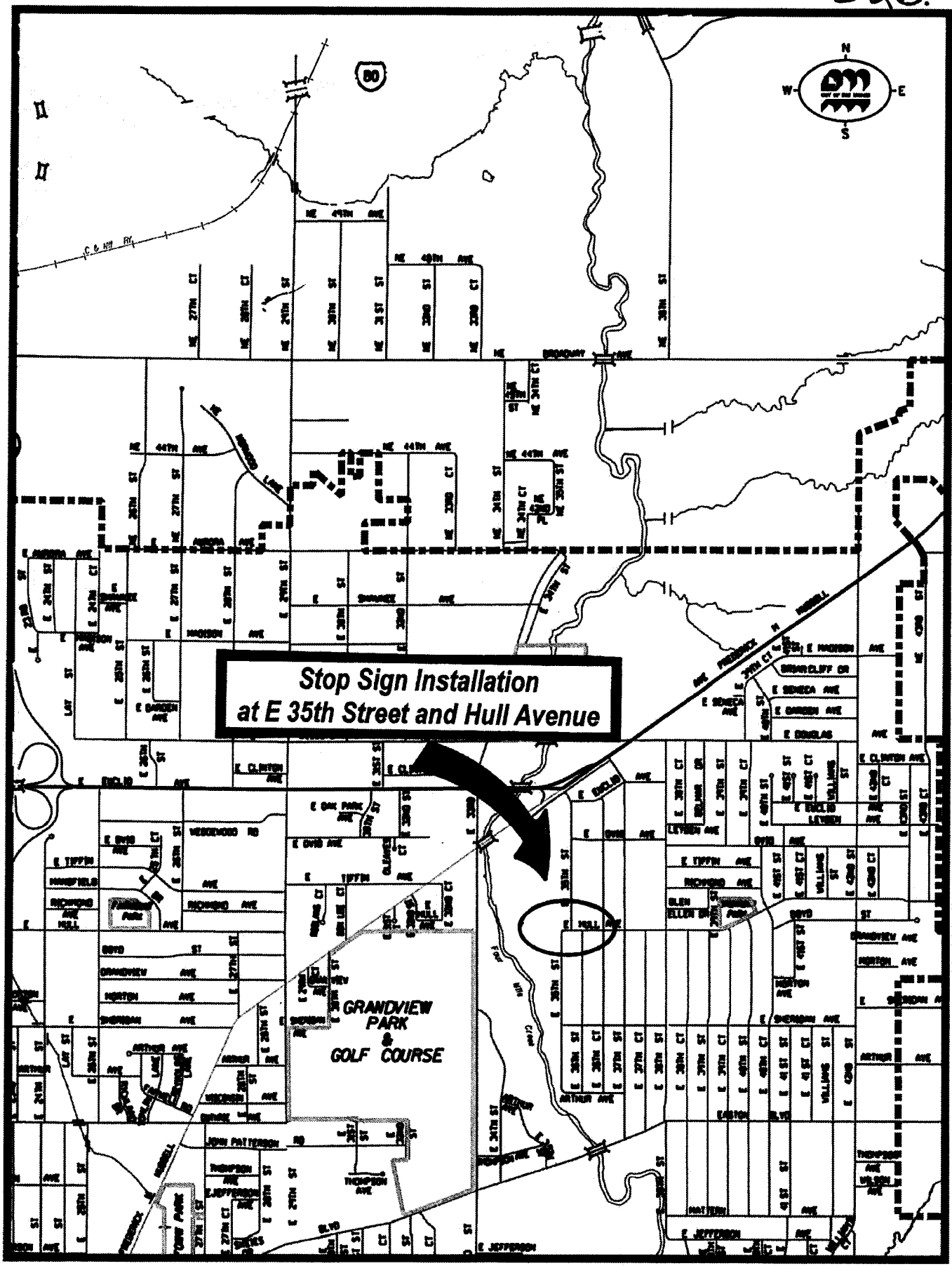
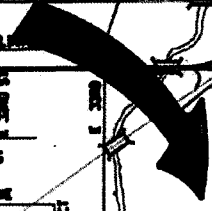

52c.

