



DATE June 11, 2012

ORDERING CONSTRUCTION OF  
2012 SEWER REPAIR - CONTRACT 2  
AND FIXING A DATE FOR RECEIVING OF BIDS ON JUNE 26, 2012  
AND PUBLIC HEARING ON JULY 9, 2012  
ENGINEER'S ESTIMATE IS \$406,000.00

BE IT RESOLVED BY THE CITY COUNCIL OF THE CITY OF DES MOINES, IOWA: That the attached communication recommending construction of the following improvement and the method of financing; and also including the recommendation of the Des Moines City Engineer, as the Engineer, submitting plans, specifications, form of contract documents, and Engineer's estimate of cost for the construction of the following improvement:

2012 Sewer Repair - Contract 2, 08-2012-002

The improvement includes installation of storm sewers, installation of manholes and intakes, placement of rip rap, grading, restoration of pavement and landscaping, and other incidental items; all work in accordance with the contract documents including Plan File Nos. 546-043/059 at the following locations: 4352 N.E. Aurora Avenue, 7001 S.W. 16th Street, S.E. 1st Street and Van Buren Street, S.W. 2nd Street and Dunham Avenue, E. 31st Street and Thompson Avenue, and Indianola Avenue and South Union Street, Des Moines, Iowa

be and the same are hereby approved and accepted. The estimated construction cost for said improvement is \$406,000.00. The proposed plans, specifications, and form of contract documents are available for public inspection in the Des Moines City Engineer's Office.

BE IT FURTHER RESOLVED: That this Council hereby determines that it is necessary and advisable to construct said improvement in the manner set forth in the plans, specifications, and form of contract documents submitted by the Engineer; and that payment for the cost of said improvement shall be paid from the funding source identified below.

BE IT FURTHER RESOLVED: That a public hearing on said plans, specifications, form of contract documents, and Engineer's estimate of construction cost for said improvement be held in the City Council Chambers, 2nd Floor, City Hall, 400 Robert D. Ray Drive, Des Moines, Iowa, at 5:00 p.m. on July 9, 2012, at which time this Council will consider any objections offered thereto or to the making of said improvement.

BE IT FURTHER RESOLVED: That proposals will be received by the City of Des Moines, at the office of the Des Moines City Clerk until 11:00 a.m. on June 26, 2012, for the construction of said improvement, and the taking of bids in the manner required by law. Proposals received will be opened at a public meeting presided over by the Engineer in the City Council Chambers, 2nd Floor, City Hall, 400 Robert D. Ray Drive, Des Moines, Iowa, at 11:00 a.m. on June 26, 2012, after which the bids together with a bid tabulation and recommendation of the Engineer will be presented to the City Council at its next meeting for action thereon.



**Roll Call Number**

**Agenda Item Number**

7C

DATE June 11, 2012

BE IT FURTHER RESOLVED: That an appropriate Notice to Bidders and Notice of Public Hearing for said improvement be published in the Des Moines Register as provided and directed by Chapter 26 and/or 314, Code of Iowa.

(City Council Communication Number 12.292 attached.)

Moved by \_\_\_\_\_ to adopt.

FORM APPROVED:

FUNDS AVAILABLE

Kathleen Vanderpool  
Deputy City Attorney

Scott E. Sanders  
Des Moines Finance Director

Funding Source: 2012-2013 CIP, Page Storm - 4, City-wide Storm Water Utility Projects, STE057, Storm Water Utility Funds

COUNCIL ACTION	YEAS	NAYS	PASS	ABSENT
COWNIE				
COLEMAN				
GRIESS				
HENSLEY				
MAHAFFEY				
MEYER				
MOORE				
TOTAL				

MOTION CARRIED

APPROVED

\_\_\_\_\_  
Mayor

I, Diane Rauh, City Clerk of said City Council, hereby certify that at a meeting of the City Council, held on the above date, among other proceedings the above was adopted.

IN WITNESS WHEREOF, I have hereunto set my hand and affixed my seal the day and year first above written.

\_\_\_\_\_  
City Clerk

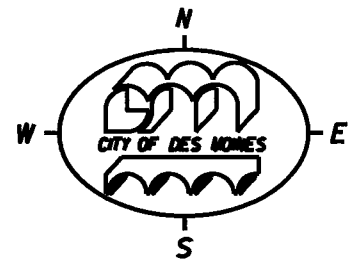
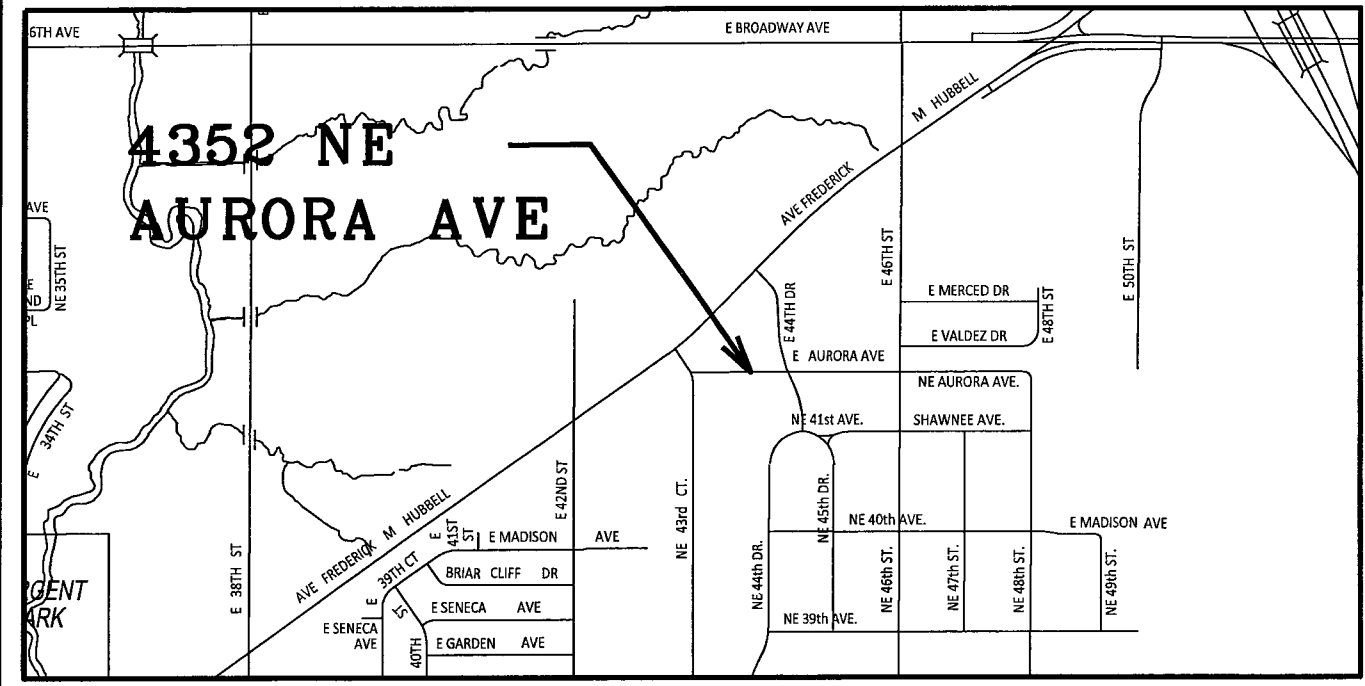

**2012 SEWER REPAIR - CONTRACT 2**  
**ACTIVITY ID 08-2012-002**  
**PAGE 1 OF 2**

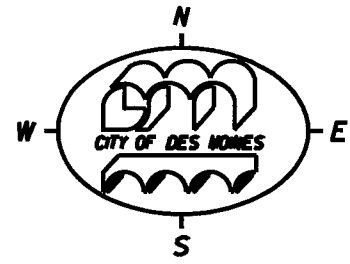
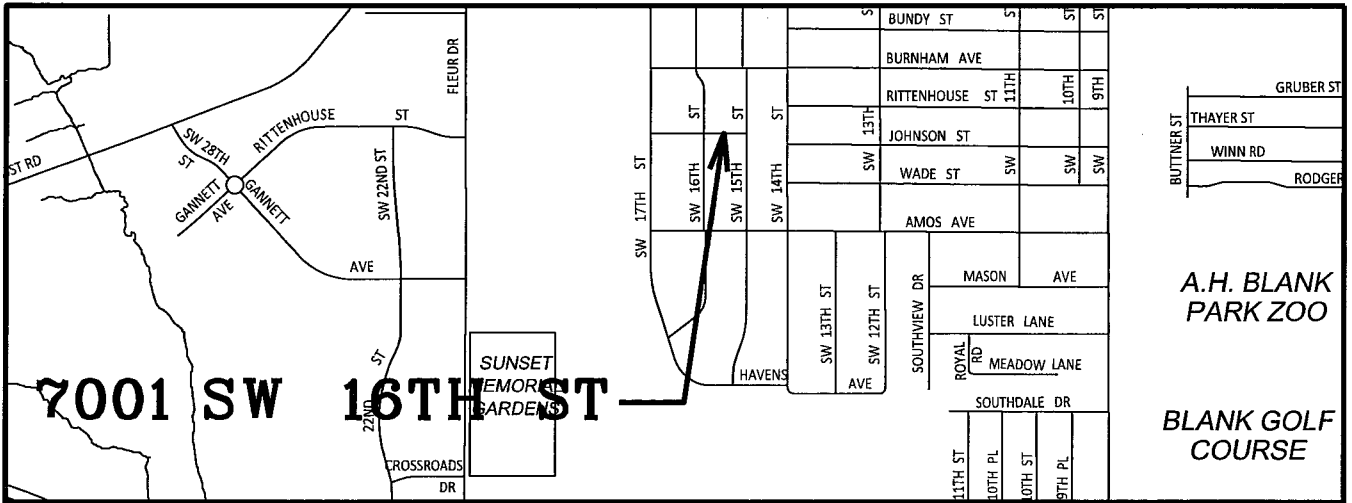
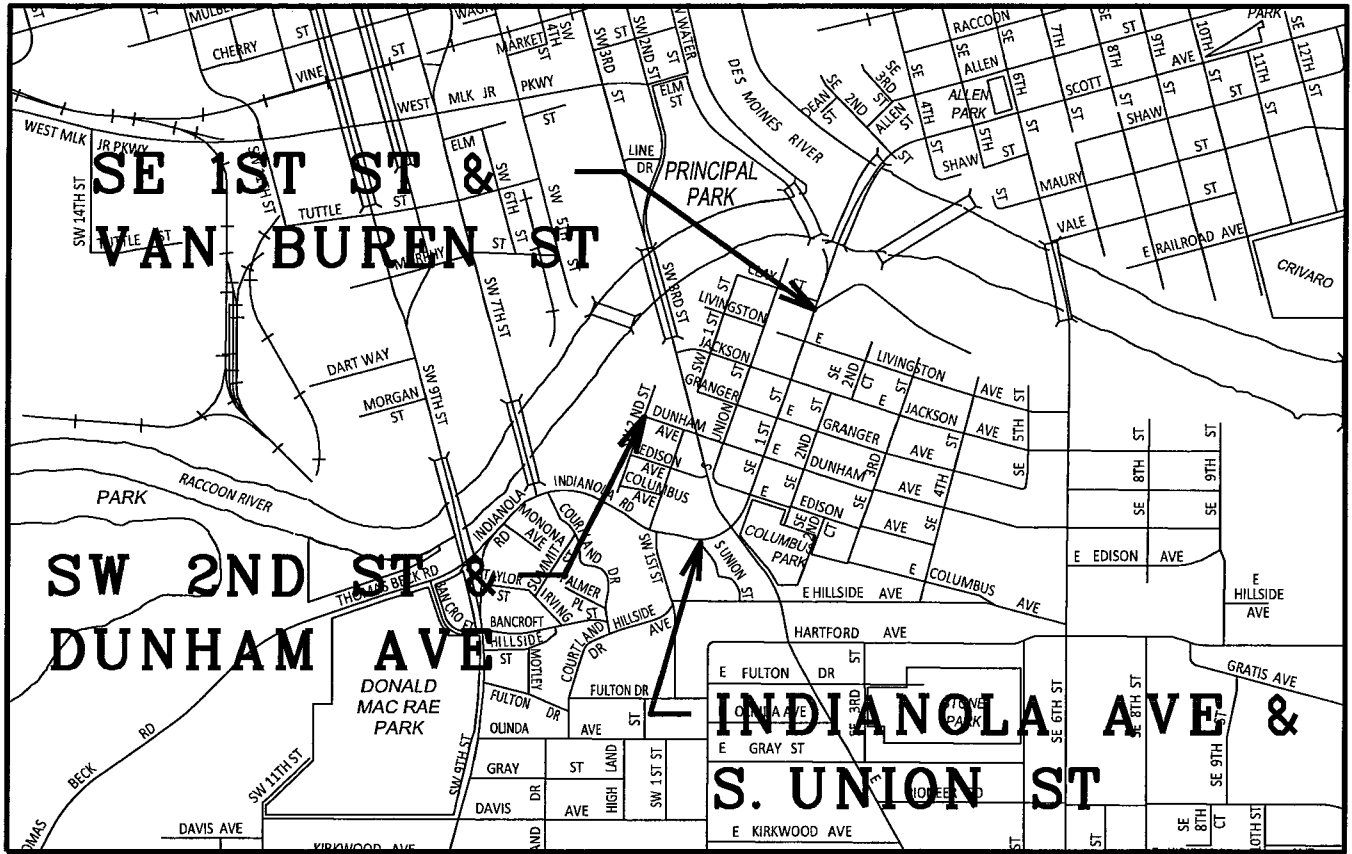

# CONSTRUCTION ESTIMATE

7C

DEPARTMENT OF ENGINEERING  
CITY OF DES MOINES, IOWA

Activity ID 08-2012-002  
Date: 05/24/12

## PROJECT: 2012 SEWER REPAIR - CONTRACT 2

NO.	DESCRIPTION	ESTIMATED UNITS			AMOUNT
		UNIT	TOTAL	UNIT PRICE	TOTAL
	<b>DIVISION 1: 4352 NE Aurora Avenue</b>				
1.01 *	Mobilization	LS	1	\$2,700.00	\$2,700.00
1.02 *	Traffic Control	LS	1	\$700.00	\$700.00
1.03 *	Project Sign Small - Standard	EACH	1	\$300.00	\$300.00
1.04 *	Removal of Existing Storm Sewer <36"	LF	64	\$30.00	\$1,920.00
1.05	Sewer, Class III RCP Storm, 15"	LF	27	\$100.00	\$2,700.00
1.06	Sewer, Class III RCP Storm, 30"	LF	66	\$175.00	\$11,550.00
1.07	Pipe Apron, 15" RCP, Apron Guard, Footing	EACH	1	\$1,200.00	\$1,200.00
1.08	Pipe Apron, 30" RCP, Apron Guard, Footing	EACH	2	\$2,000.00	\$4,000.00
1.09	Manhole, Type SW-402, 50" x 50" Minimum	EACH	1	\$7,500.00	\$7,500.00
1.10 *	Pavement Removal	SY	32	\$30.00	\$960.00
1.11	Pavement, Composite Patch	SY	22	\$110.00	\$2,420.00
1.12	Driveway, PCC 6"	SY	44	\$60.00	\$2,640.00
1.13 *	Granular Surface, Class A Crushed Stone	TON	18	\$40.00	\$720.00
1.14	Flow Transition Mat	SF	64	\$15.00	\$960.00
1.15 *	Earthwork	LS	1	\$7,000.00	\$7,000.00
1.16 *	Sodding	SQ	71	\$60.00	\$4,260.00
1.17 *	Erosion Control Measures	LF	160	\$3.00	\$480.00
1.18 *	Tree Protection	LS	1	\$650.00	\$650.00
1.19 *	Tree Protection Fence	LF	105	\$3.00	\$315.00
	<b>DIVISION 2: 7001 SW 16th Street</b>				
2.01 *	Mobilization	LS	1	\$5,600.00	\$5,600.00
2.02 *	Traffic Control	LS	1	\$700.00	\$700.00
2.03 *	Project Sign Small - Standard	EACH	1	\$300.00	\$300.00

7C

NO.	DESCRIPTION	ESTIMATED UNITS			AMOUNT
		UNIT	TOTAL	UNIT PRICE	TOTAL
2.04 *	Removal of Existing Storm Sewer <36"	LF	45	\$30.00	\$1,350.00
2.05 *	Removal of Existing Riprap	LS	1	\$7,000.00	\$7,000.00
2.06 *	Removal of Existing Storm Structure	EACH	1	\$2,000.00	\$2,000.00
2.07	Sewer, Class III RCP Storm, 36"	LF	302	\$180.00	\$54,360.00
2.08	Intake, Type SW-513	EACH	2	\$3,500.00	\$7,000.00
2.09	Manhole, Type SW-402, 48" x 56" Minimum	EACH	1	\$7,500.00	\$7,500.00
2.10	Connection to Storm Structure/Sewer	EACH	3	\$800.00	\$2,400.00
2.11 *	Earthwork	LS	1	\$7,000.00	\$7,000.00
2.12 *	Granular Surface, Class A Crushed Stone	TON	4	\$40.00	\$160.00
2.13 *	Granular Surface, Recycled Asphalt Pavement, Unclassified	TON	169	\$50.00	\$8,450.00
2.14 *	Sodding	SQ	60	\$60.00	\$3,600.00
2.15 *	Seeding, Fertilization & Mulching - Lawn Mix	SQ	220	\$35.00	\$7,700.00
2.16 *	Erosion Control Measures	LF	300	\$3.00	\$900.00
2.17 *	Tree Protection	LS	1	\$650.00	\$650.00
2.18 *	Tree Protection Fence	LF	125	\$3.00	\$375.00
	<b>DIVISION 3: SE 1st Street &amp; Van Buren Street</b>				
3.01 *	Mobilization	LS	1	\$3,600.00	\$3,600.00
3.02 *	Traffic Control	LS	1	\$1,000.00	\$1,000.00
3.03 *	Project Sign Small - Standard	EACH	1	\$300.00	\$300.00
3.04 *	Removal and Plugging Existing Gatewell	EACH	1	\$3,000.00	\$3,000.00
3.05 *	Removal of Existing Storm Structure	EACH	2	\$2,000.00	\$4,000.00
3.06 *	Plug and Abandon Existing 15" Storm Sewer	CY	15	\$210.00	\$3,150.00
3.07	Sewer, Class III RCP Storm, 15"	LF	109	\$85.00	\$9,265.00
3.08	Sewer, Class III RCP Storm, 18"	LF	103	\$100.00	\$10,300.00
3.09	Manhole, Type SW-401	EACH	1	\$5,000.00	\$5,000.00
3.10	Intake, Type SW-507	EACH	1	\$4,000.00	\$4,000.00
3.11	Intake, Type SW-509, Top Only	EACH	1	\$1,500.00	\$1,500.00
3.12	Connection to Storm Structure/Sewer	EACH	2	\$800.00	\$1,600.00

7C

NO.	DESCRIPTION	ESTIMATED UNITS			AMOUNT
		UNIT	TOTAL	UNIT PRICE	TOTAL
3.13 *	Pavement Removal	SY	13	\$30.00	\$390.00
3.14	Pavement, Composite Patch	SY	11	\$110.00	\$1,210.00
3.15	Driveway, PCC, 6"	SY	18	\$60.00	\$1,080.00
3.16 *	Sidewalk Removal	SF	977	\$3.00	\$2,931.00
3.17	Sidewalk, PCC, 4"	SF	910	\$7.00	\$6,370.00
3.18 *	Granular Surface, Class A Crushed Stone	TON	83	\$40.00	\$3,320.00
3.19 *	Earthwork	LS	1	\$2,000.00	\$2,000.00
3.20 *	Seeding, Fertilization & Mulching - Lawn Mix	SQ	50	\$35.00	\$1,750.00
3.21 *	Erosion Control Measures	LF	200	\$3.00	\$600.00
3.22 *	Tree Protection	LS	1	\$650.00	\$650.00
3.23 *	Tree Protection Fence	LF	60	\$3.00	\$180.00
	<b>DIVISION 4: SW 2nd Street and Dunham Avenue</b>				
4.01 *	Mobilization	LS	1	\$2,900.00	\$2,900.00
4.02 *	Traffic Control	LS	1	\$1,000.00	\$1,000.00
4.03 *	Project Sign Small - Standard	EACH	1	\$300.00	\$300.00
4.04 *	Clearing and Grubbing	LS	1	\$3,000.00	\$3,000.00
4.05	Sewer, Class III RCP Storm, 15"	LF	185	\$100.00	\$18,500.00
4.06	Pipe Apron, 15" RCP, Apron Guard, Footing	EACH	2	\$600.00	\$1,200.00
4.07	Manhole, Type SW-401	EACH	1	\$7,500.00	\$7,500.00
4.08 *	Pavement Removal	SY	90	\$30.00	\$2,700.00
4.09	Pavement, Composite Patch	SY	90	\$110.00	\$9,900.00
4.10 *	Earthwork	LS	1	\$5,000.00	\$5,000.00
4.11 *	Rip-Rap, Class D	TON	9	\$90.00	\$810.00
4.12 *	Sodding	SQ	40	\$60.00	\$2,400.00
4.13 *	Seeding, Fertilization & Mulching - Lawn Mix	SQ	110	\$35.00	\$3,850.00
4.14 *	Erosion Control Measures	LF	100	\$3.00	\$300.00
4.15 *	Tree Protection	LS	1	\$650.00	\$650.00
4.16 *	Tree Protection Fence	LF	263	\$3.00	\$789.00

7C

NO.	DESCRIPTION	ESTIMATED UNITS			AMOUNT
		UNIT	TOTAL	UNIT PRICE	TOTAL
	<b>DIVISION 5: E 31st Street and Thompson Avenue</b>				
5.01 *	Mobilization	LS	1	\$2,400.00	\$2,400.00
5.02 *	Traffic Control	LS	1	\$500.00	\$500.00
5.03 *	Project Sign Small - Standard	EACH	1	\$300.00	\$300.00
5.04 *	Clearing and Grubbing	LS	1	\$3,000.00	\$3,000.00
5.05 *	Removal of Existing Storm Sewer <36"	LF	10	\$30.00	\$300.00
5.06 *	Removal of Existing Storm Structure	EACH	1	\$2,000.00	\$2,000.00
5.07	Sewer, Class III RCP Storm, 18"	LF	75	\$100.00	\$7,500.00
5.08	Connection to Storm Structure/Sewer	EACH	3	\$800.00	\$2,400.00
5.09	Intake, Type SW-541	EACH	1	\$3,500.00	\$3,500.00
5.10	Intake, Type SW-507	EACH	1	\$3,500.00	\$3,500.00
5.11	Intake, Type SW-503	EACH	1	\$3,500.00	\$3,500.00
5.12 *	Sidewalk Removal	SF	66	\$3.00	\$198.00
5.13 *	Pavement Removal	SY	72	\$30.00	\$2,160.00
5.14	Pavement, Composite Patch	SY	72	\$110.00	\$7,920.00
5.15	Sidewalk, PCC, 6"	SF	66	\$8.00	\$528.00
5.16	Detectable Warnings, Truncated Domes	SF	6	\$40.00	\$240.00
5.17 *	Earthwork	LS	1	\$7,000.00	\$7,000.00
5.18 *	Sodding	SQ	20	\$60.00	\$1,200.00
5.19 *	Erosion Control Measures	LF	170	\$3.00	\$510.00
5.20 *	Tree Protection	LS	1	\$650.00	\$650.00
5.21 *	Tree Protection Fence	LF	50	\$3.00	\$150.00
	<b>DIVISION 6: Indianola Avenue and South Union Street</b>				
6.01 *	Mobilization	LS	1	\$3,162.00	\$3,162.00
6.02 *	Traffic Control	LS	1	\$1,000.00	\$1,000.00
6.03 *	Project Sign Small - Standard	EACH	1	\$300.00	\$300.00
6.04 *	Clearing and Grubbing	LS	1	\$5,000.00	\$5,000.00
6.05	Sewer, Class III RCP Storm, 15"	LF	49	\$100.00	\$4,900.00



7C

NO.	DESCRIPTION	ESTIMATED UNITS			AMOUNT
		UNIT	TOTAL	UNIT PRICE	TOTAL
6.06	Manhole, Type SW-402	EACH	1	\$5,000.00	\$5,000.00
6.07	Intake, Type SW-541	EACH	2	\$3,500.00	\$7,000.00
6.08	Intake, Type SW-512	EACH	1	\$2,500.00	\$2,500.00
6.09	Connection to Storm Structure/Sewer	EACH	2	\$1,200.00	\$2,400.00
6.10	Subdrain, Corrugated PVC, 8"	LF	414	\$18.00	\$7,452.00
6.11	Subdrain, Cleanout, 8"	EACH	3	\$400.00	\$1,200.00
6.12 *	Pavement Removal	SY	61	\$30.00	\$1,830.00
6.13	Pavement, Composite Patch	SY	31	\$110.00	\$3,410.00
6.14	Pavement, PCC, Class C Mix, 7"	SY	30	\$70.00	\$2,100.00
6.15 *	Sidewalk Removal	SF	192	\$3.00	\$576.00
6.16	Sidewalk, PCC, 4"	SF	96	\$8.00	\$768.00
6.17 *	Earthwork	LS	1	\$1,500.00	\$1,500.00
6.18	TRM, Type 3	SQ	10	\$175.00	\$1,750.00
6.19 *	Sodding	SQ	66	\$60.00	\$3,960.00
6.20 *	Erosion Control Measures	LF	190	\$4.00	\$760.00
6.21 *	Tree Protection	LS	1	\$650.00	\$650.00
6.22 *	Tree Protection Fence	LF	437	\$3.00	\$1,311.00

Prepared By: Snyder & Associates

Checked By: \_\_\_\_\_

**TOTAL CONSTRUCTION COST**

**\$406,000.00**

\* Item does not have to be included in 4-year maintenance bond, but shall be covered by a 1-year maintenance bond.

\* Estimate Total= \$156,777.00