



**Roll Call Number**

**Agenda Item Number**

56

DATE July 11, 2011

**PUBLIC HEARING, APPROVING PLANS, SPECIFICATIONS, FORM OF CONTRACT DOCUMENTS, AND ENGINEER'S ESTIMATE ON TONAWANDA DRIVE RAVINE IMPROVEMENTS; RECEIVE AND FILE BIDS; AND DESIGNATION OF LOWEST RESPONSIVE, RESPONSIBLE BIDDER AS CORELL CONTRACTOR, INC., GRANT S. CORELL, PRESIDENT, \$2,341,015.00**

WHEREAS, on June 13, 2011, under Roll Call No. 11-0972, plans, specifications, form of contract documents, and Engineer's estimate of construction cost were filed with the City Clerk, for the construction of the following improvement:

Tonawanda Drive Ravine Improvements, 08-2011-002  
I-JOBS #495

The improvement includes the stabilization of stream banks, construction of storm sewer, intakes, manholes, water mains, and curb and gutter, scarification and HMA overlay, seeding, sodding, and other incidental items; in accordance with the contract documents, including Plan File Nos. 532-150/214, located on Tonawanda Drive south of Grand Avenue, Des Moines, Iowa

WHEREAS, notice of the hearing on the plans, specifications, form of contract documents, and Engineer's estimate of construction cost was published as required by law.

NOW, THEREFORE, BE IT RESOLVED BY THE CITY COUNCIL OF THE CITY OF DES MOINES, IOWA: That the hearing on the plans, specifications, form of contract documents, and Engineer's estimate of construction cost for said improvement be closed; and that said plans, specifications, form of contract documents, and Engineer's estimate of construction cost are hereby approved as the plans, specifications, form of contract documents, and Engineer's estimate of construction cost for said improvement.

BE IT FURTHER RESOLVED: That sealed bids for said improvement were submitted by the following bidders:

- |                         |                     |
|-------------------------|---------------------|
| Corell Contractor, Inc. | West Des Moines, IA |
| McAninch Corporation    | Des Moines, IA      |

which were received and opened at a public meeting presided over by the Engineer in the City Council Chambers, 2nd Floor, City Hall, 400 Robert D. Ray Drive, Des Moines, Iowa at 11:00 a.m. on June 28, 2011. Said bids and the attached tabulation of bids for said improvement be and are hereby received and filed.

BE IT FURTHER RESOLVED: That the Des Moines City Engineer, as the Engineer, has determined that the lowest responsive, responsible bid for the construction of said improvement was submitted by Corell Contractor, Inc., Grant S. Corell, President, 1300 Lincoln Street, West Des Moines, IA, 50265 in the amount of \$2,341,015.00, and said bid be and the same is hereby accepted.

★ **Roll Call Number**

**Agenda Item Number**

56

DATE July 11, 2011

BE IT FURTHER RESOLVED: That the bid security of the unsuccessful bidders be and is hereby authorized and directed to be returned.

BE IT FURTHER RESOLVED: That the Engineer is hereby directed to secure execution by the lowest responsible, responsive Bidder and its surety of the contract documents in the form heretofore approved by this Council; that the Engineer is directed to thereafter present said contract documents to this Council for approval and authorization to the Mayor to sign; and that no contract shall be deemed to exist between the City of Des Moines and said Bidder until said contract has been executed by the Bidder, and shall have been approved by this Council and executed by the Mayor and attested to by the City Clerk.

(City Council Communication Number 11-461 attached.)

Moved by \_\_\_\_\_ to adopt.

FORM APPROVED:

FUNDS AVAILABLE

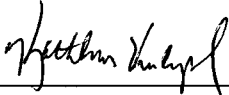

Kathleen Vanderpool  
Deputy City Attorney

Scott E. Sanders  
Des Moines Finance Director

Funding Source: 2011-2012 CIP, Page Storm-17, Tonawanda Ravines, STE082, Being: \$812,902.93 Storm Water Utility Funds; \$700,000.00 in I-JOBS II Targeted Disaster Relief Grant funds (\$700,000 maximum); \$213,259 from STR003, Asphaltic Paving Restoration Program, Page Street-5 for Tonawanda Drive resurfacing; \$95,856.40 from SAE054, City-wide Sanitary Sewers, Page Sanitary-7 for sanitary sewer protection; \$118,996.68 from Des Moines Water Works; with a transfer of \$400,000 of Storm Water Utility Funds from Hamilton Drainage Area Improvements, STE133, Page Storm-11

DEB

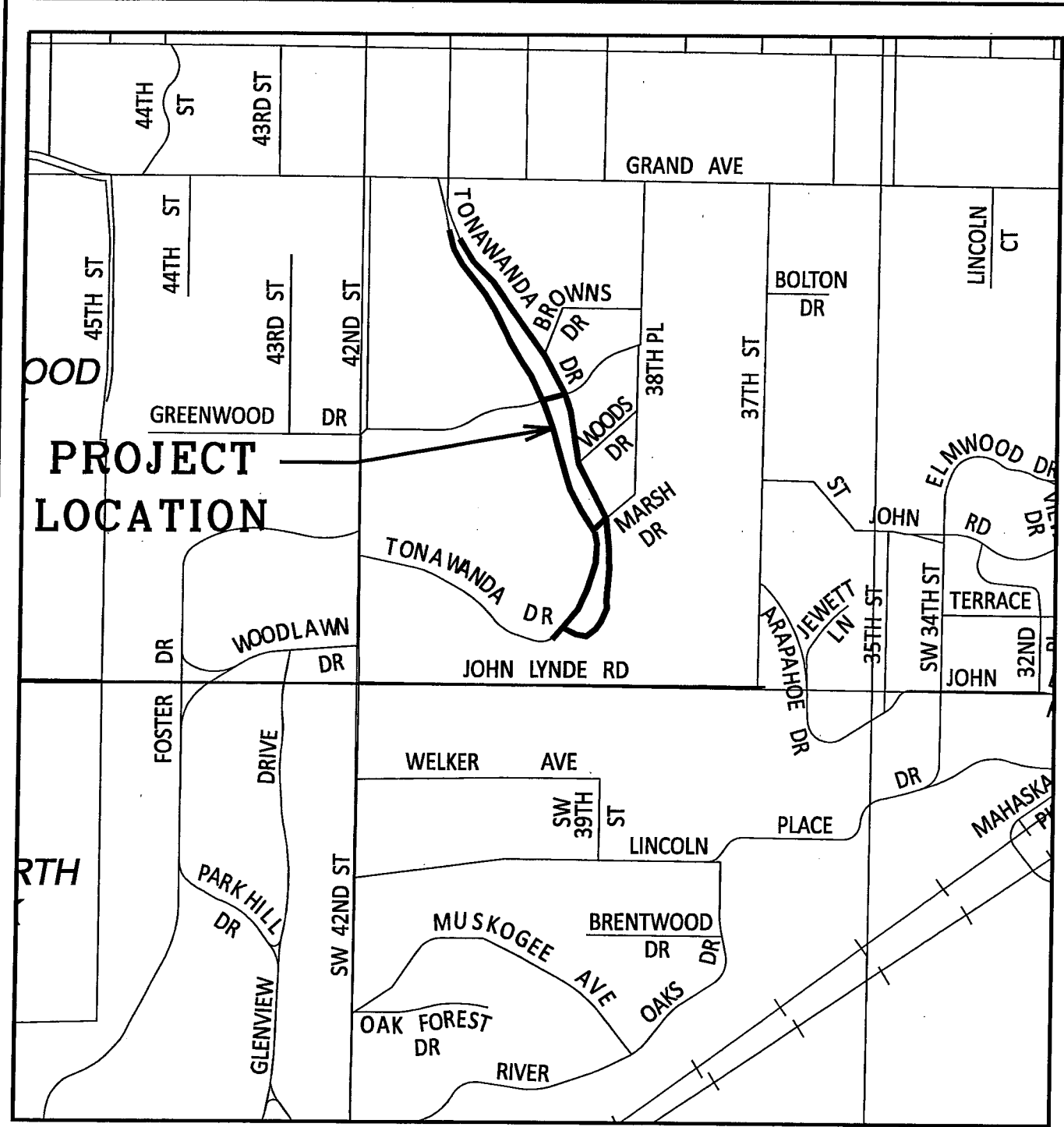

sf/le-dates

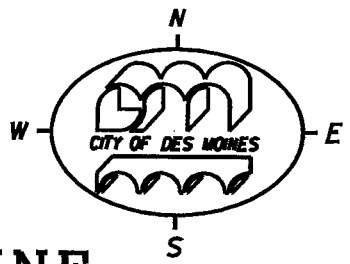

**TONAWANDA DRIVE RAVINE  
IMPROVEMENTS  
ACTIVITY I.D. 08-2011-002**

TABULATED BY: Z. Erickson  
CHECKED BY: *Z. Erickson*

APPROVED BY: *R. De Groot*

**CONTRACTOR'S BID TABULATION**  
**PROJECT: TONAWANDA DRIVE RAVINE IMPROVEMENTS**

**ESTIMATE**

ITEM	DESCRIPTION	QUANTITY	UNIT		AMOUNT	Corell Contractor, Inc. West Des Moines, IA		McAninch Corporation Des Moines, IA	
			PRICE	AMOUNT		UNIT PRICE	AMOUNT	UNIT PRICE	AMOUNT
<b>DIVISION 1 - GENERAL</b>									
1.1	MOBILIZATION	1 LS	\$130,000.00		\$130,000.00	\$158,000.00	\$141,303.00	\$141,303.00	
1.2	CONSTRUCTION SURVEY	1 LS	\$18,000.00		\$18,000.00	\$19,500.00	\$18,648.00	\$18,648.00	
1.3	PROJECT SIGN LARGE - STANDARD	1 EA	\$1,456.00		\$1,456.00	\$1,200.00	\$1,260.00	\$1,260.00	
1.4	INTERPRETIVE SIGNS	1 EA	\$4,000.00		\$4,000.00	\$4,200.00	\$4,410.00	\$4,410.00	
1.5	EROSION CONTROL	1 LS	\$3,000.00		\$3,000.00	\$6,550.00	\$6,720.00	\$6,720.00	
	<b>DIVISION 1 TOTAL =</b>				<b>\$156,456.00</b>	<b>\$189,450.00</b>	<b>\$172,341.00</b>	<b>\$172,341.00</b>	
<b>DIVISION 2 - EARTHWORK</b>									
2.1	CLEARING AND GRUBBING	1 LS	\$75,000.00		\$75,000.00	\$102,500.00	\$104,160.00	\$104,160.00	
2.2	COMPOST AMENDED TOPSOIL	937 CY	\$58.00		\$54,346.00	\$60.00	\$77.00	\$72,149.00	
2.3	CLASS 10 EXCAVATION	1050 CY	\$80.00		\$84,000.00	\$80.00	\$11.00	\$11,550.00	
2.4	SPECIAL FILL	65 CY	\$30.00		\$1,950.00	\$25.00	\$110.00	\$7,150.00	
2.5	SUBGRADE PREPARATION	3922 SY	\$7.50		\$29,415.00	\$7.30	\$6.00	\$23,532.00	
2.6	SUBGRADE TREATMENT, GEOTEXTILE	2882 SY	\$4.00		\$11,528.00	\$3.75	\$8.00	\$23,056.00	
2.7	GRANULAR SUBBASE, TYPE A	3922 SY	\$29.415		\$29,415.00	\$7.30	\$13.00	\$50,986.00	
2.8	REMOVAL OF GABIONS	21 CY	\$160.00		\$3,360.00	\$160.00	\$149.00	\$3,129.00	
2.9	REMOVE AND REPLACE RIPRAP	141 SY	\$35.00		\$4,935.00	\$35.00	\$64.00	\$9,024.00	
2.10	MISCELLANEOUS REMOVALS	1 LS	\$4,000.00		\$4,000.00	\$4,000.00	\$11,000.00	\$11,000.00	
	<b>DIVISION 2 TOTAL =</b>				<b>\$297,949.00</b>	<b>\$324,708.70</b>	<b>\$315,736.00</b>	<b>\$315,736.00</b>	
<b>DIVISION 4 - SEWERS &amp; DRAINS</b>									
4.1	FILLING AND CAPPING OF KNOWN PIPES, VCP, 18 IN.	65 LF	\$26.00		\$1,690.00	\$26.00	\$28.00	\$1,820.00	
4.2	REMOVE AND REPLACE SANITARY SEWER, D.I.P., 12 IN.	40 LF	\$260.00		\$10,400.00	\$260.00	\$131.00	\$5,240.00	
4.3	REMOVAL OF STORM SEWER, PVC, 8 IN. AND VCP, 8 IN.	65 LF	\$30.00		\$1,950.00	\$30.00	\$36.00	\$2,340.00	
4.4	REMOVAL OF STORM SEWER, VCP, 10 IN.	76 LF	\$30.00		\$2,280.00	\$30.00	\$37.00	\$2,812.00	
4.5	REMOVAL OF STORM SEWER, VCP, 12 IN.	8 LF	\$30.00		\$240.00	\$30.00	\$134.00	\$1,072.00	
4.6	REMOVAL OF STORM SEWER, RCP, 15 IN.	18 LF	\$540.00		\$9,720.00	\$30.00	\$59.00	\$1,062.00	
4.7	REMOVAL OF STORM SEWER, VCP, 18 IN.	20 LF	\$30.00		\$600.00	\$30.00	\$53.00	\$1,060.00	
4.8	REMOVAL OF STORM SEWER, RCP, 30 IN.	82 LF	\$30.00		\$2,460.00	\$30.00	\$44.00	\$3,608.00	
4.9	REMOVAL OF STORM SEWER, RCP, 42 IN.	67 LF	\$30.00		\$2,010.00	\$30.00	\$57.00	\$3,819.00	
4.10	STORM SEWER PIPE, TRENCHED, 2000D (CLASS III), RCP, 15 IN.	1083 LF	\$110.00		\$119,130.00	\$106.00	\$227.00	\$245,841.00	
4.11	STORM SEWER PIPE, TRENCHED, 2000D (CLASS III), RCP, 18 IN.	16 LF	\$150.00		\$2,400.00	\$146.00	\$194.00	\$3,104.00	
4.12	STORM SEWER PIPE, TRENCHED, 2000D (CLASS III), RCP, 24 IN.	120 LF	\$120.00		\$14,400.00	\$118.00	\$145.00	\$17,400.00	
4.13	STORM SEWER PIPE, TRENCHED, 2000D (CLASS III), RCP, 30 IN.	12 LF	\$210.00		\$2,520.00	\$207.00	\$197.00	\$2,364.00	
4.14	STORM SEWER PIPE, TRENCHED, 2000D (CLASS III), RCP, 60 IN.	68 LF	\$340.00		\$23,120.00	\$340.00	\$296.00	\$20,128.00	
4.15	STORM SEWER PIPE, TRENCHED, 2000D (CLASS III), RCP, 72 IN.	70 LF	\$550.00		\$38,500.00	\$545.00	\$432.00	\$30,240.00	
4.16	STORM SEWER APRON, 2000 (CLASS III) RCP, 15 IN.	17 EA	\$1,200.00		\$20,400.00	\$1,190.00	\$1,079.00	\$18,343.00	
4.17	STORM SEWER APRON, 2000 (CLASS III) RCP, 24 IN.	1 EA	\$1,460.00		\$1,460.00	\$1,460.00	\$1,339.00	\$1,339.00	
4.18	STORM SEWER APRON, 2000 (CLASS III) RCP, 30 IN.	1 EA	\$1,550.00		\$1,550.00	\$1,550.00	\$1,680.00	\$1,680.00	
4.19	STORM SEWER APRON, 2000 (CLASS III) RCP, 60 IN.	2 EA	\$2,300.00		\$4,600.00	\$5,200.00	\$3,261.00	\$6,522.00	
4.20	STORM SEWER APRON, 2000 (CLASS III) RCP, 72 IN.	2 EA	\$5,750.00		\$11,500.00	\$5,725.00	\$3,891.00	\$7,782.00	
4.21	SUBDRAIN, TYPE 1, CORRUGATED PVC, 6 IN.	60 LF	\$27.00		\$1,620.00	\$26.50	\$30.00	\$1,800.00	

56

ITEM	DESCRIPTION	QUANTITY	UNIT PRICE	AMOUNT	UNIT PRICE	AMOUNT	UNIT PRICE	AMOUNT
4.22	SUBDRAIN CLEANOUT, TYPE 1	1 EA	\$300.00	\$300.00	\$300.00	\$300.00	\$372.00	\$372.00
4.23	CMP SUBDRAIN OUTLET AND SUBDRAIN CONNECTIONS	1 EA	\$350.00	\$350.00	\$325.00	\$325.00	\$223.00	\$223.00
	<b>DIVISION 4 TOTAL =</b>			<b>\$264,020.00</b>		<b>\$264,523.00</b>		<b>\$379,971.00</b>
5.1	<b>DIVISION 5 -WATER MAINS AND APPURTENANCES</b>	1 LS	\$5,500.00	\$5,500.00	\$5,500.00	\$5,500.00	\$1,675.00	\$1,675.00
5.2	PREPARE EXCAVATION FOR TAPPING SLEEVE AND VALVE	30 TON	\$20.00	\$600.00	\$20.00	\$600.00	\$32.00	\$960.00
5.3	FOUNDATION ROCK	93 LF	\$235.00	\$21,855.00	\$235.00	\$21,855.00	\$163.00	\$15,159.00
5.4	WATER MAIN, 8 IN. C-900 PVC PIPE, TRENCHED	5 EA	\$340.00	\$1,700.00	\$340.00	\$1,700.00	\$1,046.00	\$5,230.00
5.5	WATER MAIN, 8 IN. DIA. BEND	1 EA	\$575.00	\$575.00	\$575.00	\$575.00	\$218.00	\$218.00
5.6	WATER MAIN, 8 IN. DIA. CAP/PLUG	1 EA	\$3,800.00	\$3,800.00	\$3,750.00	\$3,750.00	\$3,611.00	\$3,611.00
5.7	FIRE HYDRANT ASSEMBLY	1 LS	\$8,500.00	\$8,500.00	\$8,500.00	\$8,500.00	\$6,872.00	\$6,872.00
5.8	WATER MAIN, 8 IN. DIAMETER RELOCATION 1	1 LS	\$8,500.00	\$8,500.00	\$8,500.00	\$8,500.00	\$6,872.00	\$6,872.00
5.9	WATER MAIN, 8 IN. DIAMETER RELOCATION 2	1 LS	\$8,500.00	\$8,500.00	\$8,500.00	\$8,500.00	\$6,872.00	\$6,872.00
5.10	WATER MAIN, 8 IN. DIAMETER RELOCATION 3	1 LS	\$8,500.00	\$8,500.00	\$8,500.00	\$8,500.00	\$6,871.00	\$6,871.00
5.11	WATER MAIN, 8 IN. DIAMETER RELOCATION 4	1 LS	\$14,000.00	\$14,000.00	\$14,000.00	\$14,000.00	\$9,956.00	\$9,956.00
5.12	WATER MAIN, 8 IN. DIAMETER RELOCATION 5	1 LS	\$14,500.00	\$14,500.00	\$14,500.00	\$14,500.00	\$10,912.00	\$10,912.00
5.13	WATER MAIN, 8 IN. DIAMETER RELOCATION 6	1 LS	\$8,500.00	\$8,500.00	\$8,500.00	\$8,500.00	\$6,872.00	\$6,872.00
5.14	WATER MAIN, 8 IN. DIAMETER RELOCATION 7	1 LS	\$8,500.00	\$8,500.00	\$8,500.00	\$8,500.00	\$6,872.00	\$6,872.00
5.15	WATER MAIN, 8 IN. DIAMETER RELOCATION 8	1 LS	\$7,100.00	\$7,100.00	\$7,100.00	\$7,100.00	\$3,224.00	\$3,224.00
5.16	NEW 1 IN. WATER SERVICE, OPPOSITE SIDE OF RAVINE	1 LS	\$2,150.00	\$2,150.00	\$2,150.00	\$2,150.00	\$2,200.00	\$2,200.00
	<b>DIVISION 5 TOTAL =</b>			<b>\$122,780.00</b>		<b>\$122,730.00</b>		<b>\$94,376.00</b>
6.1	<b>DIVISION 6 -STRUCTURES FOR SANITARY &amp; STORM</b>	12 EA	\$3,300.00	\$39,600.00	\$3,285.00	\$39,420.00	\$3,886.00	\$46,632.00
6.2	MANHOLE, M-A	20 EA	\$2,600.00	\$52,000.00	\$2,600.00	\$52,000.00	\$3,620.00	\$72,400.00
6.3	INTAKE, TYPE M-A	2 EA	\$4,000.00	\$8,000.00	\$3,975.00	\$7,950.00	\$6,716.00	\$13,432.00
6.4	INTAKE, TYPE M-C	22 EA	\$4,100.00	\$90,200.00	\$4,100.00	\$90,200.00	\$5,970.00	\$131,340.00
6.5	INTAKE, TYPE M-D	1 EA	\$6,800.00	\$6,800.00	\$6,785.00	\$6,785.00	\$7,120.00	\$7,120.00
6.6	INTAKE, TYPE M-E	1 EA	\$5,900.00	\$5,900.00	\$5,850.00	\$5,850.00	\$5,702.00	\$5,702.00
6.7	CONNECTION TO EXISTING PIPE	5 EA	\$1,000.00	\$5,000.00	\$975.00	\$4,875.00	\$3,212.00	\$16,060.00
6.8	CONNECTION TO EXISTING INTAKE OR MANHOLE STRUCTURE	1 EA	\$1,700.00	\$1,700.00	\$1,670.00	\$1,670.00	\$3,863.00	\$3,863.00
6.9	REMOVAL OF INTAKES AND MANHOLES	7 EA	\$750.00	\$5,250.00	\$750.00	\$5,250.00	\$1,722.00	\$12,054.00
6.10	MANHOLE ADJUSTMENT, MAJOR TYPE 1	3 EA	\$1,300.00	\$3,900.00	\$1,300.00	\$3,900.00	\$1,567.00	\$4,701.00
6.11	MANHOLE ADJUSTMENT, MINOR TYPE 2	11 EA	\$1,600.00	\$17,600.00	\$1,610.00	\$17,710.00	\$677.00	\$7,447.00
	<b>DIVISION 6 TOTAL =</b>			<b>\$235,950.00</b>		<b>\$235,610.00</b>		<b>\$320,751.00</b>
7.1	<b>DIVISION 7 -STREETS &amp; RELATED WORK</b>	155 SY	\$8.00	\$1,240.00	\$8.00	\$1,240.00	\$28.00	\$4,340.00
7.2	REMOVAL OF SIDEWALK	2 SY	\$46.00	\$92.00	\$46.00	\$92.00	\$54.00	\$108.00
7.3	SIDEWALK, P.C. CONCRETE, 6 IN.	152 SY	\$51.00	\$7,752.00	\$51.00	\$7,752.00	\$51.00	\$7,752.00
7.4	DETECTABLE WARNING, TRUNCATED DOMES	56 SF	\$35.00	\$1,960.00	\$31.00	\$1,736.00	\$34.00	\$1,904.00
7.5	CURB AND GUTTER, P.C. CONCRETE, TYPE 1	4930 LF	\$22.00	\$108,460.00	\$22.00	\$108,460.00	\$24.00	\$118,320.00
7.6	CURB AND GUTTER, P.C. CONCRETE, TYPE 2	34 LF	\$24.00	\$816.00	\$24.00	\$816.00	\$24.00	\$816.00
7.7	CURB AND GUTTER, P.C. CONCRETE, TYPE 3	198 LF	\$62.00	\$12,276.00	\$62.00	\$12,276.00	\$89.00	\$17,622.00
7.8	PAVEMENT REMOVAL, PCC AND ACC	2682 SY	\$16.00	\$42,912.00	\$16.75	\$44,841.50	\$30.00	\$80,460.00
7.9	BASE PAVEMENT, P.C., CONCRETE, 7 IN.	919 SY	\$50.00	\$45,950.00	\$51.00	\$46,869.00	\$52.00	\$47,788.00
7.10	BASE PAVEMENT, P.C., CONCRETE, 7 IN., REINFORCED	122 SY	\$60.00	\$7,320.00	\$60.00	\$7,320.00	\$79.00	\$9,638.00
7.11	PAVEMENT SCARIFICATION/MILLING FOR RESURFACING	8169 SY	\$6.00	\$49,014.00	\$6.00	\$49,014.00	\$11.00	\$89,859.00
7.12	HMA (1M ESAL) INTERMEDIATE AND SURFACE COURSE, 1/2 IN MIX	1535 TON	\$100.00	\$153,500.00	\$107.00	\$164,245.00	\$110.00	\$168,850.00
7.13	GRANULAR SURFACING, TEMPORARY ROADWAY	400 TON	\$30.00	\$12,000.00	\$30.00	\$12,000.00	\$46.00	\$18,400.00
	<b>DIVISION 7 TOTAL =</b>			<b>\$443,292.00</b>		<b>\$448,913.50</b>		<b>\$565,857.00</b>
8.1	<b>DIVISION 8 -TRAFFIC SIGNALIZATION/TRAFFIC CONTROL</b>	1 LS	\$19,500.00	\$19,500.00	\$11,500.00	\$11,500.00	\$8,925.00	\$8,925.00
	TRAFFIC CONTROL							

56

ITEM	DESCRIPTION	QUANTITY	UNIT PRICE	AMOUNT	UNIT PRICE	AMOUNT	UNIT PRICE	AMOUNT
8.2	FLAGGERS	40 DAY	\$450.00	\$18,000.00	\$900.00	\$36,000.00	\$945.00	\$37,800.00
		DIVISION 8 TOTAL =		\$37,500.00		\$47,500.00		\$46,725.00
9.1	DIVISION 9-SITE WORK & LANDSCAPING	1060 SY	\$8.00	\$8,480.00	\$18.00	\$19,080.00	\$11.00	\$11,660.00
9.2	SPECIAL VEGETATION REMOVAL	55 SQ	\$62.00	\$3,410.00	\$61.50	\$3,382.50	\$63.00	\$3,465.00
9.3	SODDING	255 SQ	\$25.00	\$6,375.00	\$19.50	\$4,972.50	\$20.00	\$5,100.00
9.4	SEEDING, TYPE 1	272 SQ	\$25.00	\$6,800.00	\$21.50	\$5,848.00	\$22.00	\$5,984.00
9.5	SEEDING, TYPE 2	50 EA	\$240.00	\$12,000.00	\$240.00	\$12,000.00	\$244.00	\$12,200.00
9.6	TREES	60 EA	\$50.00	\$3,000.00	\$50.00	\$3,000.00	\$51.00	\$3,060.00
9.7	SHRUBS	845 EA	\$10.00	\$8,450.00	\$9.25	\$7,816.25	\$9.00	\$7,605.00
9.8	PLUGS	3243 EA	\$19.00	\$61,617.00	\$18.50	\$59,995.50	\$19.00	\$61,617.00
9.9	LIVE STAKES	1 LS	\$6,000.00	\$6,000.00	\$5,550.00	\$5,550.00	\$5,670.00	\$5,670.00
9.10	TREE PROTECTION	2000 LF	\$2.50	\$5,000.00	\$2.40	\$4,800.00	\$2.00	\$4,000.00
9.11	TREE PROTECTION FENCE	2371 TON	\$81.00	\$192,051.00	\$81.00	\$192,051.00	\$72.00	\$170,712.00
9.12	REVETMENT FOR BANK STABILIZATION, CLASS A (TYPE 1)	723 TON	\$85.00	\$61,455.00	\$84.60	\$61,165.80	\$110.00	\$79,530.00
9.13	REVETMENT FOR BANK STABILIZATION, CLASS D (TYPE 2)	1185 LF	\$16.00	\$18,960.00	\$15.50	\$18,367.50	\$16.00	\$18,960.00
9.14	COIR LOG (WATTLE) FOR BANK STABILIZATION (TYPE 1)	269 SY	\$120.00	\$32,280.00	\$120.00	\$32,280.00	\$123.00	\$33,087.00
9.15	VGSS FOR BANK STABILIZATION (TYPE 2)	2895 SY	\$3.00	\$8,685.00	\$3.00	\$8,685.00	\$3.00	\$8,685.00
9.16	RECP FOR BANK STABILIZATION (TYPE 1 & 2)	490 LF	\$2.50	\$1,225.00	\$2.40	\$1,176.00	\$2.00	\$980.00
9.17	FILTER SOCKS, (size), INSTALLATION AND REMOVAL	1000 LF	\$2.50	\$2,500.00	\$2.40	\$2,400.00	\$2.00	\$2,000.00
9.18	SILT FENCE	1000 LF	\$1.00	\$1,000.00	\$1.05	\$1,050.00	\$1.00	\$1,000.00
9.19	REMOVAL OF SILT FENCE	46 EA	\$125.00	\$5,750.00	\$125.00	\$5,750.00	\$126.00	\$5,796.00
9.20	INLET PROTECTION DEVICE	7 EA	\$13,500.00	\$94,500.00	\$12,775.00	\$89,425.00	\$23,125.00	\$161,875.00
9.21	ROCK CROSS VANE STRUCTURE	855 TON	\$75.00	\$64,125.00	\$75.00	\$64,125.00	\$85.00	\$72,675.00
9.22	ROCK OUTLET PROTECTION, CLASS A RIPRAP	1091 TON	\$72.00	\$78,552.00	\$70.50	\$76,915.50	\$72.00	\$78,552.00
9.23	ROCK OUTLET PROTECTION, CLASS B RIPRAP	375 TON	\$70.00	\$26,250.00	\$69.75	\$26,156.25	\$89.00	\$33,375.00
9.24	ROCK OUTLET PROTECTION, CLASS D RIPRAP	4 TON	\$288.00	\$1,152.00	\$288.00	\$1,152.00	\$110.00	\$440.00
9.25	EROSION STONE	50 TON	\$26.00	\$1,300.00	\$26.00	\$1,300.00	\$68.00	\$3,400.00
	STABILIZED CONSTRUCTION ENTRANCE	DIVISION 9 TOTAL =		\$710,053.00		\$707,579.80		\$791,428.00
	TOTAL CONSTRUCTION COST			\$2,268,000.00		\$2,341,015.00		\$2,687,185.00
	PERCENT OF ENGINEER'S ESTIMATE					+3.22%		+18.48%
						(Low)		