



DATE September 11, 2006

PUBLIC HEARING, APPROVING PLANS, SPECIFICATIONS, FORM OF CONTRACT DOCUMENTS, AND ENGINEER'S ESTIMATE ON LEETOWN CREEKWAY WOODEN BOX REPLACEMENT - PHASE 4; RECEIVE AND FILE BIDS; AND DESIGNATION OF LOWEST RESPONSIBLE, RESPONSIVE BIDDER AS VAN HAUEN & ASSOCIATES, INC., MARK VAN HAUEN, CEO/VICE PRESIDENT, \$925,000.00

WHEREAS, on August 7, 2006, under Roll Call No. 06-1552, plans, specifications, form of contract documents, and Jurisdictional Engineer's estimate of construction cost were filed with the City Clerk, for the construction of the following improvement:

Leetown Creekway Wooden Box Replacement - Phase 4, 08-2006-004

The improvement includes replacement of the existing timber box culvert with a reinforced concrete box culvert including all labor, material, and equipment necessary to replace approximately 827 linear feet of existing 7 ft. x 4.5 ft. timber box culvert with a 10 ft. x 4 ft. reinforced concrete box culvert, along with the necessary clearing and grubbing; traffic control; PCC street, driveway, and sidewalk removal and replacement; storm sewer, manhole, and intake removal and replacement; sanitary sewer and sewer service removal and replacement; sanitary sewer manhole construction; fence removal and replacement; residential house structural support investigation and installation; garage removal; construction survey; sod restoration; all in accordance with the contract documents including Plan File Nos. 464-141/157 from the existing reinforced concrete box culvert located south and west of the intersection of E. 27th Court and Kinsey Avenue, northwesterly along the existing timber box culvert line to the existing reinforced concrete box culvert located south and west of the intersection of E. 27th Street and Easton Boulevard, Des Moines, Iowa

WHEREAS, notice of the hearing on the plans, specifications, form of contract documents, and Engineer's estimate of construction cost was published as required by law.

NOW, THEREFORE, BE IT RESOLVED BY THE CITY COUNCIL OF THE CITY OF DES MOINES, IOWA: That the hearing on the plans, specifications, form of contract documents, and Jurisdictional Engineer's estimate of construction cost for said improvement be closed; and that said plans, specifications, form of contract documents, and Jurisdictional Engineer's estimate of construction cost are hereby approved as the plans, specifications, form of contract documents, and Jurisdictional Engineer's estimate of construction cost for said improvement.

BE IT FURTHER RESOLVED: That sealed bids for said improvement were submitted by the following bidders:



Roll Call Number

Agenda Item Number

69

DATE September 11, 2006

Van Hauen & Associates, Inc.	Clive, IA
The Underground Company, Ltd.	Carlisle, IA
H & W Contracting LLC	Sioux Falls, SD
Synergy Contracting LLC	Ankeny, IA
Jenco Construction Inc.	Des Moines, IA

which were received and opened at a public meeting presided over by the Jurisdictional Engineer in the City Council Chambers, 2nd Floor, City Hall, 400 Robert D. Ray Drive, Des Moines, Iowa at 11:00 a.m. on August 29, 2006. Said bids and the attached tabulation of bids for said improvement be and are hereby received and filed.

BE IT FURTHER RESOLVED: That the Jurisdictional Engineer has determined that the lowest responsible, responsive bid for the construction of said improvement was submitted by Van Hauen & Associates, Inc., Mark Van Hauen, CEO/Vice President, 13185 Pineview Drive, Clive, IA, 50325 in the amount of \$925,000.00, and said bid be and the same is hereby accepted.

BE IT FURTHER RESOLVED: That the bid security of the unsuccessful bidders be and is hereby authorized and directed to be returned.

BE IT FURTHER RESOLVED: That the Jurisdictional Engineer is hereby directed to secure execution by the lowest responsible, responsive Bidder and its surety of the contract documents in the form heretofore approved by this Council; that the Jurisdictional Engineer is directed to thereafter present said contract documents to this Council for approval and authorization to the Mayor to sign; and that no contract shall be deemed to exist between the City of Des Moines and said Bidder until said contract has been executed by the Bidder, and shall have been approved by this Council and executed by the Mayor and attested to by the City Clerk.

(City Council Communication Number 06-581 attached.)

Moved by _____ to adopt.

FORM APPROVED:



 Kathleen Vanderpool
 Deputy City Attorney

FUNDS AVAILABLE



 Allen McKinley
 Des Moines Finance Director

★ **Roll Call Number**

Agenda Item Number

69

DATE September 11, 2006

Funding Source: 2006-2007 CIP, Page Storm-13, Leetown Creekway - Wooden Box Replacement, STE064,
Being: Storm Water Revenue Bonds to be issued

COUNCIL ACTION	YEAS	NAYS	PASS	ABSENT
COWNIE				
COLEMAN				
HENSLEY				
KIERNAN				
MAHAFFEY				
VLISSIS				
TOTAL				
MOTION CARRIED			APPROVED	

CERTIFICATE

I, DIANE RAUH, City Clerk of said City hereby certify that at a meeting of the City Council of said City of Des Moines, held on the above date, among other proceedings the above was adopted.

IN WITNESS WHEREOF, I have hereunto set my hand and affixed my seal the day and year first above written.

Mayor

City Clerk

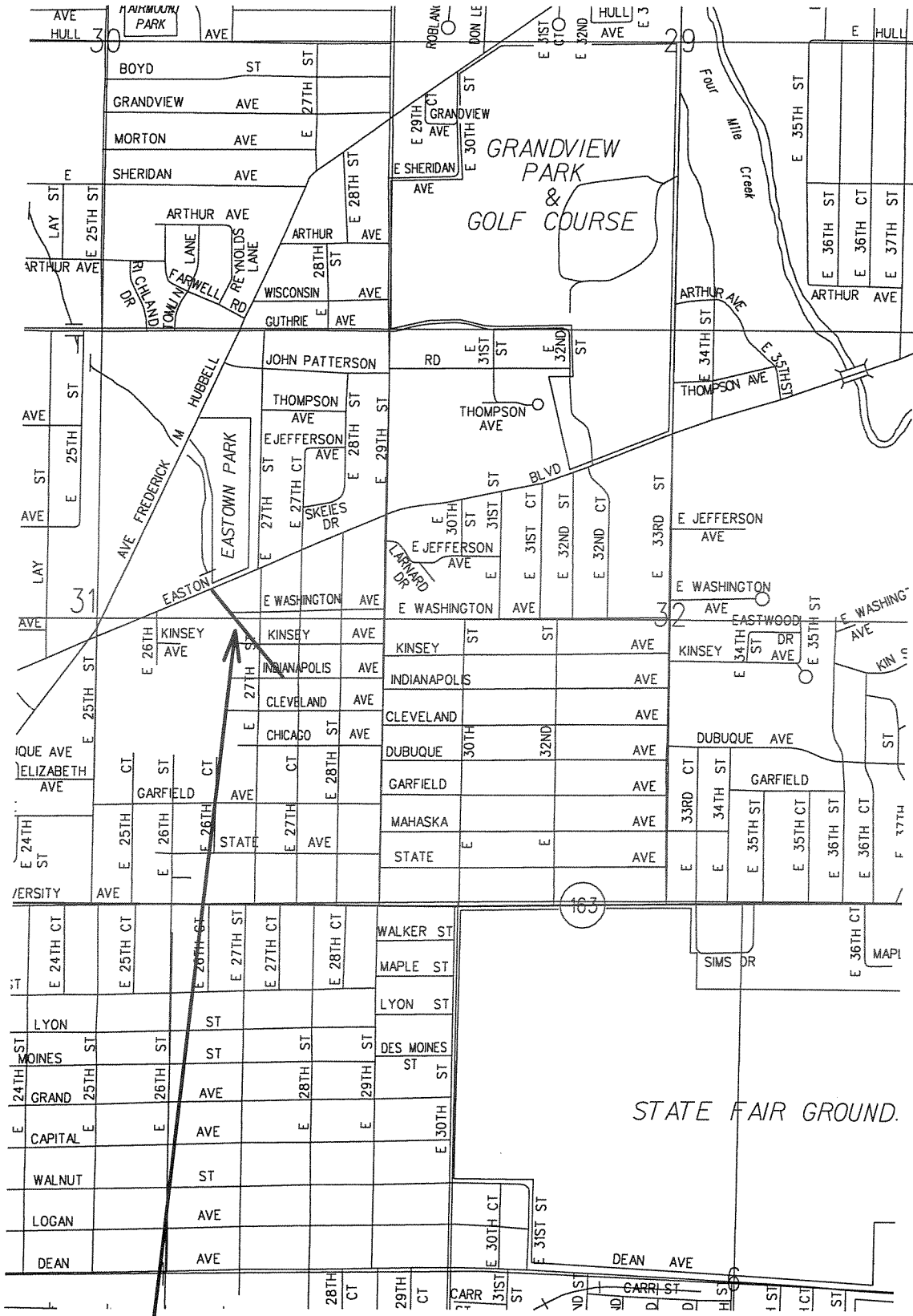

69

**PROPERTY
LOCATION**

LEETOWN CREEKWAY

WOODEN BOX REPLACEMENT - PHASE 4

ACTIVITY I.D. 08-2006-004

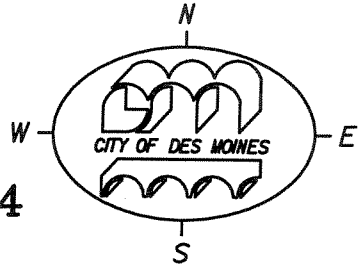

TABULATED BY: John Boehmer APPROVED BY: John F. McKee
CHECKED BY: Drew R.

CONTRACTOR'S BID TABULATION

PROJECT: Leetown Creekway Wooden Box Replacement - Phase 4, Kinsey Avenue to Easton Blvd.

ESTIMATE

ITEM	DESCRIPTION	QUANTITY	UNIT		AMOUNT		BID PRICE		UNIT PRICE	AMOUNT		UNIT PRICE	BID PRICE		UNIT PRICE	AMOUNT	
			PRICE	AMOUNT	PRICE	AMOUNT	PRICE	AMOUNT		PRICE	AMOUNT		PRICE	AMOUNT		PRICE	AMOUNT
1	Mobilization	1 LS	\$50,000.00	\$50,000.00	\$35,000.00	\$35,000.00	\$68,500.00	\$68,500.00	\$20,000.00	\$20,000.00							
2	Clearing	272 Dia-in.	\$40.00	\$10,880.00	\$65.00	\$17,680.00	\$15.00	\$4,080.00	\$7.50	\$2,040.00							
3	Grubbing, Greater than 6" Dia.	272 Dia-in.	\$40.00	\$10,880.00	\$65.00	\$17,680.00	\$15.00	\$4,080.00	\$7.50	\$2,040.00							
4	Grubbing, Less than 6" Dia.	1 LS	\$5,000.00	\$5,000.00	\$10,000.00	\$10,000.00	\$2,000.00	\$2,000.00	\$12,000.00	\$12,000.00							
5	Core Out Excavation	500 CY	\$20.00	\$10,000.00	\$1.00	\$500.00	\$1.00	\$500.00	\$13.00	\$6,500.00							
6	Traffic Control	1 LS	\$8,000.00	\$8,000.00	\$8,500.00	\$8,500.00	\$3,500.00	\$3,500.00	\$4,000.00	\$4,000.00							
7	PCC Driveway Removal	545 SY	\$10.00	\$5,450.00	\$5.00	\$2,725.00	\$8.00	\$4,360.00	\$9.00	\$4,905.00							
8	Pavement Removal	923 SY	\$12.00	\$11,076.00	\$5.00	\$4,615.00	\$10.00	\$9,230.00	\$9.00	\$8,307.00							
9	PCC Sidewalk Removal	110 SY	\$8.00	\$880.00	\$5.00	\$550.00	\$6.00	\$660.00	\$6.75	\$742.50							
10	Drill and Dowel Pavement	403 LF	\$12.00	\$4,836.00	\$7.00	\$2,821.00	\$13.00	\$5,239.00	\$8.00	\$3,224.00							
11	Subgrade Preparation	1080 SY	\$5.00	\$5,400.00	\$5.00	\$5,400.00	\$5.00	\$5,400.00	\$6.00	\$6,480.00							
12	Pavement, Non-Reinforced PCC Class C, 7"	923 SY	\$45.00	\$41,535.00	\$50.00	\$46,150.00	\$48.00	\$44,304.00	\$38.00	\$35,074.00							
13	Pavement Reinforcing Steel	653 SY	\$10.00	\$6,530.00	\$9.795.00	\$6,390.00	\$12.00	\$7,836.00	\$3.50	\$2,285.50							
14	Driveway, 6" PCC	545 SY	\$35.00	\$19,075.00	\$44.00	\$23,980.00	\$37.00	\$20,165.00	\$32.75	\$17,848.75							
15	Sidewalk, 4" PCC	110 SY	\$30.00	\$3,300.00	\$35.00	\$3,850.00	\$35.00	\$3,850.00	\$36.50	\$4,015.00							
16	Granular Surfacing, Class A Crushed Stone	140 Tons	\$14.00	\$1,960.00	\$25.00	\$3,500.00	\$17.00	\$2,380.00	\$18.00	\$2,520.00							
17	Removal of Existing Timber Box Culvert	823 LF	\$60.00	\$49,380.00	\$35.00	\$28,805.00	\$53.00	\$43,619.00	\$121.00	\$99,583.00							
18	Trench Bottom Stabilization	500 CY	\$25.00	\$12,500.00	\$5.00	\$2,500.00	\$25.00	\$12,500.00	\$21.00	\$10,500.00							
19	Granular Backfill	500 CY	\$25.00	\$12,500.00	\$5.00	\$2,500.00	\$25.00	\$12,500.00	\$15.00	\$7,500.00							
20	Removal, 8" Storm Sewer	11 LF	\$10.00	\$110.00	\$10.00	\$110.00	\$15.00	\$165.00	\$16.00	\$176.00							
21	Removal, 15" Storm Sewer	137 LF	\$10.00	\$1,370.00	\$10.00	\$1,370.00	\$15.00	\$2,055.00	\$15.75	\$2,157.75							
22	Removal, 24" Storm Sewer	120 LF	\$10.00	\$1,200.00	\$15.00	\$1,800.00	\$17.00	\$2,040.00	\$15.75	\$1,890.00							
23	Remove, Storm Sewer Intake	4 EA	\$500.00	\$2,000.00	\$500.00	\$2,000.00	\$450.00	\$1,800.00	\$500.00	\$2,000.00							
24	Remove, Storm Sewer Manhole	4 EA	\$500.00	\$2,000.00	\$500.00	\$2,000.00	\$550.00	\$2,200.00	\$500.00	\$2,000.00							
25	10' x 4' Reinforced Concrete Box Culvert	827 LF	\$650.00	\$537,550.00	\$532.00	\$439,964.00	\$603.00	\$498,681.00	\$533.00	\$440,791.00							
26	Storm Sewer, PVC, 8"	6 LF	\$30.00	\$180.00	\$35.00	\$210.00	\$115.00	\$690.00	\$147.00	\$882.00							
27	Storm Sewer, 2000D, 15"	12 LF	\$100.00	\$1,200.00	\$100.00	\$1,200.00	\$116.00	\$1,392.00	\$135.25	\$1,623.00							
28	Storm Sewer, 2000D, 18"	30 LF	\$100.00	\$3,000.00	\$150.00	\$4,500.00	\$93.00	\$2,790.00	\$127.50	\$3,825.00							
29	Storm Sewer, 2000D, 24"	101 LF	\$120.00	\$12,120.00	\$175.00	\$17,675.00	\$103.00	\$10,403.00	\$147.00	\$14,847.00							
30	Storm Sewer, 2000D, 30"	93 LF	\$125.00	\$11,625.00	\$200.00	\$18,600.00	\$115.00	\$10,695.00	\$160.00	\$14,880.00							
31	Storm Sewer Connection to RCB	6 EA	\$1,000.00	\$6,000.00	\$750.00	\$4,500.00	\$1,500.00	\$9,000.00	\$1,500.00	\$9,000.00							
32	Box Culvert Connection Removal - E. 27th Court	1 LS	\$4,000.00	\$4,000.00	\$7,500.00	\$7,500.00	\$3,500.00	\$3,500.00	\$6,500.00	\$6,500.00							
33	Box Culvert Connection Removal - Easton Blvd.	1 LS	\$4,000.00	\$4,000.00	\$7,500.00	\$7,500.00	\$12,200.00	\$12,200.00	\$6,500.00	\$6,500.00							
34	Intake, Type M-C	2 EA	\$3,500.00	\$7,000.00	\$2,000.00	\$4,000.00	\$2,950.00	\$5,900.00	\$3,000.00	\$6,000.00							
35	Intake, Type M-E	2 EA	\$4,000.00	\$8,000.00	\$2,500.00	\$5,000.00	\$4,500.00	\$9,000.00	\$4,000.00	\$8,000.00							
36	Manhole, Type M-C	2 EA	\$9,000.00	\$18,000.00	\$3,300.00	\$6,600.00	\$4,500.00	\$9,000.00	\$3,500.00	\$7,000.00							
37	Manhole, Modified M-E	3 EA	\$5,000.00	\$15,000.00	\$1,500.00	\$4,500.00	\$4,600.00	\$13,800.00	\$4,000.00	\$12,000.00							
38	Modified "RCP Area" Intake	2 EA	\$2,500.00	\$5,000.00	\$1,000.00	\$2,000.00	\$1,000.00	\$2,000.00	\$2,000.00	\$4,000.00							
39	Water Services	170 LF	\$30.00	\$5,100.00	\$35.00	\$5,950.00	\$40.00	\$6,800.00	\$74.00	\$12,580.00							
40	Sanitary Sewer Removal	33 LF	\$25.00	\$825.00	\$10.00	\$330.00	\$25.00	\$825.00	\$15.50	\$511.50							
41	Sanitary Sewer, 10" PVC	127 LF	\$100.00	\$12,700.00	\$100.00	\$12,700.00	\$60.00	\$7,620.00	\$134.00	\$17,018.00							

01

ITEM	DESCRIPTION	QUANTITY	UNIT PRICE	AMOUNT	UNIT PRICE	AMOUNT	UNIT PRICE	AMOUNT	UNIT PRICE	AMOUNT
42	Sewer Pipe Supports	8 EA	\$400.00	\$3,200.00	\$250.00	\$2,000.00	\$550.00	\$4,400.00	\$1,200.00	\$9,600.00
43	Manhole, Type I Sanitary Sewer	2 EA	\$3,000.00	\$6,000.00	\$4,000.00	\$8,000.00	\$3,200.00	\$6,400.00	\$3,200.00	\$6,400.00
44	Sanitary Sewer Service	140 LF	\$50.00	\$7,000.00	\$50.00	\$7,000.00	\$61.00	\$8,540.00	\$123.00	\$17,220.00
45	Fence Removal and Replacement	550 LF	\$20.00	\$11,000.00	\$19.00	\$10,450.00	\$18.00	\$9,900.00	\$18.00	\$9,900.00
46	Temporary Fence	161 LF	\$15.00	\$2,415.00	\$10.00	\$1,610.00	\$7.00	\$1,127.00	\$26.00	\$4,186.00
47	Sodding	533 SQ	\$50.00	\$26,650.00	\$60.00	\$31,980.00	\$50.00	\$26,650.00	\$38.00	\$20,254.00
48	Silt Fence (Install and Remove)	200 LF	\$5.00	\$1,000.00	\$2.00	\$400.00	\$5.00	\$1,000.00	\$3.25	\$650.00
49	Emergency Trench Connection	10 EA	\$1,000.00	\$10,000.00	\$1,500.00	\$15,000.00	\$1.00	\$10.00	\$1,200.00	\$12,000.00
50	Structural Support Investigation	1 LS	\$10,000.00	\$10,000.00	\$10,000.00	\$10,000.00	\$8,000.00	\$8,000.00	\$10,000.00	\$10,000.00
51	Structural Support Investigation	4 EA	\$4,000.00	\$16,000.00	\$2,500.00	\$10,000.00	\$500.00	\$2,000.00	\$4,000.00	\$16,000.00
52	Water Main Lowering	4 EA	\$10,000.00	\$40,000.00	\$6,000.00	\$24,000.00	\$500.00	\$2,000.00	\$13,500.00	\$54,000.00
53	Erosion Control	1 LS	\$5,000.00	\$5,000.00	\$15,000.00	\$15,000.00	\$3,500.00	\$3,500.00	\$5,000.00	\$5,000.00
54	Project Sign	1 LS	\$1,000.00	\$1,000.00	\$1,000.00	\$1,000.00	\$700.00	\$700.00	\$700.00	\$700.00
55	Construction Survey	1 LS	\$15,000.00	\$15,000.00	\$9,000.00	\$9,000.00	\$6,500.00	\$6,500.00	\$7,000.00	\$7,000.00
56	Removal of Existing Garage	1 LS	\$3,500.00	\$3,500.00	\$3,000.00	\$3,000.00	\$2,000.00	\$2,000.00	\$1,500.00	\$1,500.00
				\$1,075,927.00		\$925,000.00		\$949,986.00		\$998,156.00
TOTAL CONSTRUCTION COST										
PERCENT OF ENGINEER'S ESTIMATE						-14.03%		-11.71%		-7.23%
					Low					

DEPARTMENT OF ENGINEERING
CITY OF DES MOINES, IOWA

TABULATED BY: John Bohmer
CHECKED BY: Bruce R. APPROVED BY: John F. McKee

CONTRACTOR'S BID TABULATION

PROJECT: Leetown Creekway Wooden Box Replacement - Phase 4, Kinsey Avenue to Easton Blvd.

ESTIMATE

ITEM	DESCRIPTION	QUANTITY	UNIT		AMOUNT	Synergy Contracting LLC Ankeny, IA		Jenco Construction Inc. Des Moines, IA	
			PRICE	AMOUNT		UNIT PRICE	AMOUNT	UNIT PRICE	AMOUNT
1	Mobilization	1 LS	\$50,000.00	\$50,000.00	\$50,000.00	\$35,993.00	\$35,993.00	\$300,000.00	\$300,000.00
2	Clearing	272 Dia-in.	\$40.00	\$10,880.00	\$10,880.00	\$50.00	\$13,600.00	\$45.00	\$12,240.00
3	Grubbing, Greater than 6" Dia.	272 Dia-in.	\$40.00	\$10,880.00	\$10,880.00	\$20.00	\$5,440.00	\$45.00	\$12,240.00
4	Grubbing, Less than 6" Dia.	1 LS	\$5,000.00	\$5,000.00	\$5,000.00	\$4,000.00	\$4,000.00	\$7,500.00	\$7,500.00
5	Core Out Excavation	500 CY	\$20.00	\$10,000.00	\$10,000.00	\$5.00	\$2,500.00	\$22.00	\$11,000.00
6	Traffic Control	1 LS	\$8,000.00	\$8,000.00	\$8,000.00	\$4,500.00	\$4,500.00	\$9,000.00	\$9,000.00
7	PCC Driveway Removal	545 SY	\$10.00	\$5,450.00	\$5,450.00	\$11.00	\$5,995.00	\$11.00	\$5,995.00
8	Pavement Removal	923 SY	\$12.00	\$11,076.00	\$11,076.00	\$14.00	\$12,922.00	\$13.00	\$11,999.00
9	PCC Sidewalk Removal	110 SY	\$8.00	\$880.00	\$880.00	\$14.00	\$1,540.00	\$9.00	\$990.00
10	Drill and Dowel Pavement	403 LF	\$12.00	\$4,836.00	\$4,836.00	\$8.00	\$3,224.00	\$13.00	\$5,239.00
11	Subgrade Preparation	1080 SY	\$5.00	\$5,400.00	\$5,400.00	\$5.00	\$5,400.00	\$6.00	\$6,480.00
12	Pavement, Non-Reinforced PCC Class C, 7"	923 SY	\$45.00	\$41,535.00	\$41,535.00	\$37.00	\$34,151.00	\$50.00	\$46,150.00
13	Pavement Reinforcing Steel	653 SY	\$10.00	\$6,530.00	\$6,530.00	\$3.25	\$2,122.25	\$12.00	\$7,836.00
14	Driveway, 6" PCC	545 SY	\$35.00	\$19,075.00	\$19,075.00	\$33.00	\$17,985.00	\$37.00	\$20,165.00
15	Sidewalk, 4" PCC	110 SY	\$30.00	\$3,300.00	\$3,300.00	\$37.00	\$4,070.00	\$35.00	\$3,850.00
16	Granular Surfacing, Class A Crushed Stone	140 Tons	\$14.00	\$1,960.00	\$1,960.00	\$31.00	\$4,340.00	\$16.00	\$2,240.00
17	Removal of Existing Timber Box Culvert	823 LF	\$60.00	\$49,380.00	\$49,380.00	\$60.00	\$49,380.00	\$75.00	\$61,725.00
18	Trench Bottom Stabilization	500 CY	\$25.00	\$12,500.00	\$12,500.00	\$25.00	\$12,500.00	\$30.00	\$15,000.00
19	Granular Backfill	500 CY	\$25.00	\$12,500.00	\$12,500.00	\$24.00	\$12,000.00	\$30.00	\$15,000.00
20	Removal, 8" Storm Sewer	11 LF	\$10.00	\$110.00	\$110.00	\$24.00	\$264.00	\$12.00	\$132.00
21	Removal, 15" Storm Sewer	137 LF	\$10.00	\$1,370.00	\$1,370.00	\$24.00	\$3,288.00	\$12.00	\$1,644.00
22	Removal, 24" Storm Sewer	120 LF	\$10.00	\$1,200.00	\$1,200.00	\$24.00	\$2,880.00	\$12.00	\$1,440.00
23	Remove, Storm Sewer Intake	4 EA	\$500.00	\$2,000.00	\$2,000.00	\$500.00	\$2,000.00	\$600.00	\$2,400.00
24	Remove, Storm Sewer Manhole	4 EA	\$500.00	\$2,000.00	\$2,000.00	\$500.00	\$2,000.00	\$600.00	\$2,400.00
25	10' x 4' Reinforced Concrete Box Culvert	827 LF	\$650.00	\$537,550.00	\$537,550.00	\$679.00	\$561,593.00	\$950.00	\$785,650.00
26	Storm Sewer, PVC, 8"	6 LF	\$30.00	\$180.00	\$180.00	\$84.00	\$504.00	\$35.00	\$210.00
27	Storm Sewer, 2000D, 15"	12 LF	\$100.00	\$1,200.00	\$1,200.00	\$88.00	\$1,056.00	\$120.00	\$1,440.00
28	Storm Sewer, 2000D, 18"	30 LF	\$100.00	\$3,000.00	\$3,000.00	\$91.00	\$2,730.00	\$120.00	\$3,600.00
29	Storm Sewer, 2000D, 24"	101 LF	\$120.00	\$12,120.00	\$12,120.00	\$104.00	\$10,504.00	\$125.00	\$12,625.00
30	Storm Sewer, 2000D, 30"	93 LF	\$125.00	\$11,625.00	\$11,625.00	\$120.00	\$11,160.00	\$130.00	\$12,090.00
31	Storm Sewer Connection to RCB	6 EA	\$1,830.00	\$10,980.00	\$10,980.00	\$1,830.00	\$10,980.00	\$2,200.00	\$13,200.00
32	Box Culvert Connection Removal - E. 27th Court	1 LS	\$4,000.00	\$4,000.00	\$4,000.00	\$7,199.00	\$7,199.00	\$4,200.00	\$4,200.00
33	Box Culvert Connection Removal - Easton Blvd.	1 LS	\$4,000.00	\$4,000.00	\$4,000.00	\$7,199.00	\$7,199.00	\$4,750.00	\$4,750.00
34	Intake, Type M-C	2 EA	\$3,500.00	\$7,000.00	\$7,000.00	\$3,698.00	\$7,396.00	\$4,000.00	\$8,000.00
35	Intake, Type M-E	2 EA	\$4,000.00	\$8,000.00	\$8,000.00	\$5,762.00	\$11,524.00	\$4,500.00	\$9,000.00
36	Manhole, Type M-C	2 EA	\$4,500.00	\$9,000.00	\$9,000.00	\$6,958.00	\$13,916.00	\$5,000.00	\$10,000.00
37	Manhole, Modified M-E	3 EA	\$5,000.00	\$15,000.00	\$15,000.00	\$5,291.00	\$15,873.00	\$5,500.00	\$16,500.00
38	Modified "RCP Area" Intake	2 EA	\$2,500.00	\$5,000.00	\$5,000.00	\$2,607.00	\$5,214.00	\$3,000.00	\$6,000.00
39	Water Services	170 LF	\$30.00	\$5,100.00	\$5,100.00	\$43.00	\$7,310.00	\$35.00	\$5,950.00
40	Sanitary Sewer Removal	33 LF	\$25.00	\$825.00	\$825.00	\$24.00	\$792.00	\$30.00	\$990.00
41	Sanitary Sewer, 10" PVC	127 LF	\$100.00	\$12,700.00	\$12,700.00	\$79.00	\$10,033.00	\$150.00	\$19,050.00

ITEM	DESCRIPTION	QUANTITY		AMOUNT		UNIT PRICE		AMOUNT		UNIT PRICE		AMOUNT	
42	Sewer Pipe Supports	8	EA	\$3,200.00		\$400.00		\$4,000.00		\$750.00		\$6,000.00	
43	Manhole, Type I Sanitary Sewer	2	EA	\$6,000.00		\$3,000.00		\$5,507.00		\$4,000.00		\$8,000.00	
44	Sanitary Sewer Service	140	LF	\$7,000.00		\$50.00		\$7,700.00		\$55.00		\$7,700.00	
45	Fence Removal and Replacement	550	LF	\$11,000.00		\$20.00		\$9,625.00		\$25.00		\$13,750.00	
46	Temporary Fence	161	LF	\$2,415.00		\$15.00		\$805.00		\$20.00		\$3,220.00	
47	Sodding	533	SQ	\$26,650.00		\$50.00		\$20,254.00		\$55.00		\$29,315.00	
48	Silt Fence (Install and Remove)	200	LF	\$1,000.00		\$5.00		\$700.00		\$6.00		\$1,200.00	
49	Emergency Trench Connection	10	EA	\$10,000.00		\$1,000.00		\$5,000.00		\$1,200.00		\$12,000.00	
50	Structural Support Investigation	1	LS	\$10,000.00		\$10,000.00		\$20,000.00		\$5,000.00		\$5,000.00	
51	Structural Support Installation	4	EA	\$16,000.00		\$4,000.00		\$16,000.00		\$5,500.00		\$22,000.00	
52	Water Main Lowering	4	EA	\$40,000.00		\$9,766.00		\$39,064.00		\$15,000.00		\$60,000.00	
53	Erosion Control	1	LS	\$5,000.00		\$5,000.00		\$10,000.00		\$7,500.00		\$7,500.00	
54	Project Sign	1	LS	\$1,000.00		\$1,000.00		\$750.00		\$2,000.00		\$2,000.00	
55	Construction Survey	1	LS	\$15,000.00		\$15,000.00		\$9,000.00		\$17,000.00		\$17,000.00	
56	Removal of Existing Garage	1	LS	\$3,500.00		\$3,500.00		\$5,000.00		\$5,000.00		\$5,000.00	
				\$1,075,927.00				\$1,086,429.25				\$1,669,605.00	
TOTAL CONSTRUCTION COST													
PERCENT OF ENGINEER'S ESTIMATE													+55.18%