

DATE July 10, 2006

ORDERING CONSTRUCTION OF
TWANA/BEL-AIRE STORM SEWER IMPROVEMENTS
AND FIXING A DATE FOR RECEIVING OF BIDS ON JULY 25, 2006
AND PUBLIC HEARING ON AUGUST 7, 2006
ENGINEER'S ESTIMATE IS \$1,325,235.00

BE IT RESOLVED BY THE CITY COUNCIL OF THE CITY OF DES MOINES, IOWA: That the attached communication recommending construction of the following improvement and the method of financing; and also including the recommendation of the Des Moines City Engineer, as the Jurisdictional Engineer, submitting plans, specifications, form of contract documents, and Jurisdictional Engineer's estimate of cost for the construction of the following improvement:

Twana/Bel-Aire Storm Sewer Improvements, 08-2006-003

The improvement includes construction of a relief storm sewer totaling 1,752 linear feet of 12" through 54" reinforced concrete pipe, construction of an 8' x 6' reinforced concrete box culvert, and other incidental items; in accordance with the contract documents, including Plans File Nos. 463-061/076 in the general area east of Lower Beaver Road between Lindlavista Way and Valdez Drive, Des Moines, Iowa

be and the same are hereby approved and accepted. The estimated construction cost for said improvement is \$1,325,235.00. The proposed plans, specifications, and form of contract documents are available for public inspection in the City Engineer's Office.

BE IT FURTHER RESOLVED: That this Council hereby determines that it is necessary and advisable to construct said improvement in the manner set forth in the plans, specifications, and form of contract documents submitted by the Jurisdictional Engineer; and that payment for the cost of said improvement shall be paid from from the funding source identified below.

BE IT FURTHER RESOLVED: That a public hearing on said plans, specifications, form of contract documents, and Jurisdictional Engineer's estimate of construction cost for said improvement be held in the City Council Chambers, 2nd Floor, City Hall, 400 Robert D. Ray Drive, Des Moines, Iowa, at 5:00 p.m. on August 7, 2006, at which time this Council will consider any objections offered thereto or to the making of said improvement.

BE IT FURTHER RESOLVED: That proposals will be received by the City of Des Moines, at the office of the City Clerk until 11:00 a.m. on July 25, 2006, for the construction of said improvement, and the taking of bids in the manner required by law. Proposals received will be opened at a public meeting presided over by the Jurisdictional Engineer in the City Council Chambers, 2nd Floor, City Hall, 400 Robert D. Ray Drive, Des Moines, Iowa, at 11:00 a.m. on July 25, 2006, after which the bids together with a bid tabulation and recommendation of the Jurisdictional Engineer will be presented to the City Council at its next meeting for action thereon.

BE IT FURTHER RESOLVED: That the City Clerk is further directed to publish a Public Notice of Storm Water Discharge in the Des Moines Register and The Business Record as required by the Iowa Department of Natural Resources.

★ **Roll Call Number**

Agenda Item Number

6 F

DATE July 10, 2006

BE IT FURTHER RESOLVED: That the City Manager be and is hereby authorized and directed to certify the "Notice of Intent for NPDES Coverage under General Permit No. 2 for Storm Water Discharges associated with Industrial Activity for Construction Activities" on behalf of the City of Des Moines and submit said document to the Iowa Department of Natural Resources with appropriate application and permit fees.

BE IT FURTHER RESOLVED: That an appropriate Notice to Bidders and Notice of Public Hearing for said improvement be published in the Des Moines Register as provided and directed by Chapter 384, Code of Iowa.

(City Council Communication Number 06-A35 attached.)

Moved by _____ to adopt.

FORM APPROVED:

FUNDS AVAILABLE

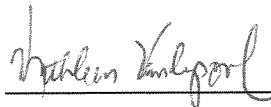
 Kathleen Vanderpool
 Deputy City Attorney

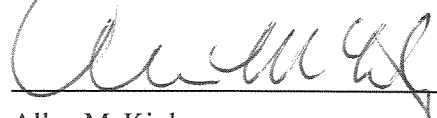
 Allen McKinley
 Acting Des Moines Finance Director

JFB Funding Source: 2006-2007 CIP, Page Storm-15, Twana/Bel-Aire Storm Sewer Improvements, STE079, Various Funding, Being: \$400,000 in Storm Water Utility Funds from STE079, \$150,000 developer contribution toward the cost of the relief storm sewer, and a transfer of \$775,235 in Storm Water Utility Funds from Closes Creek Watershed Improvements, STE068

COUNCIL ACTION	YEAS	NAYS	PASS	ABSENT
COWNIE				
BROOKS				
COLEMAN				
HENSLEY				
KIERNAN				
MAHAFFEY				
VLASSIS				
TOTAL				

MOTION CARRIED APPROVED

Mayor

I, Diane Rauh, City Clerk of said City Council, hereby certify that at a meeting of the City Council, held on the above date, among other proceedings the above was adopted.

IN WITNESS WHEREOF, I have hereunto set my hand and affixed my seal the day and year first above written.

City Clerk

6 F

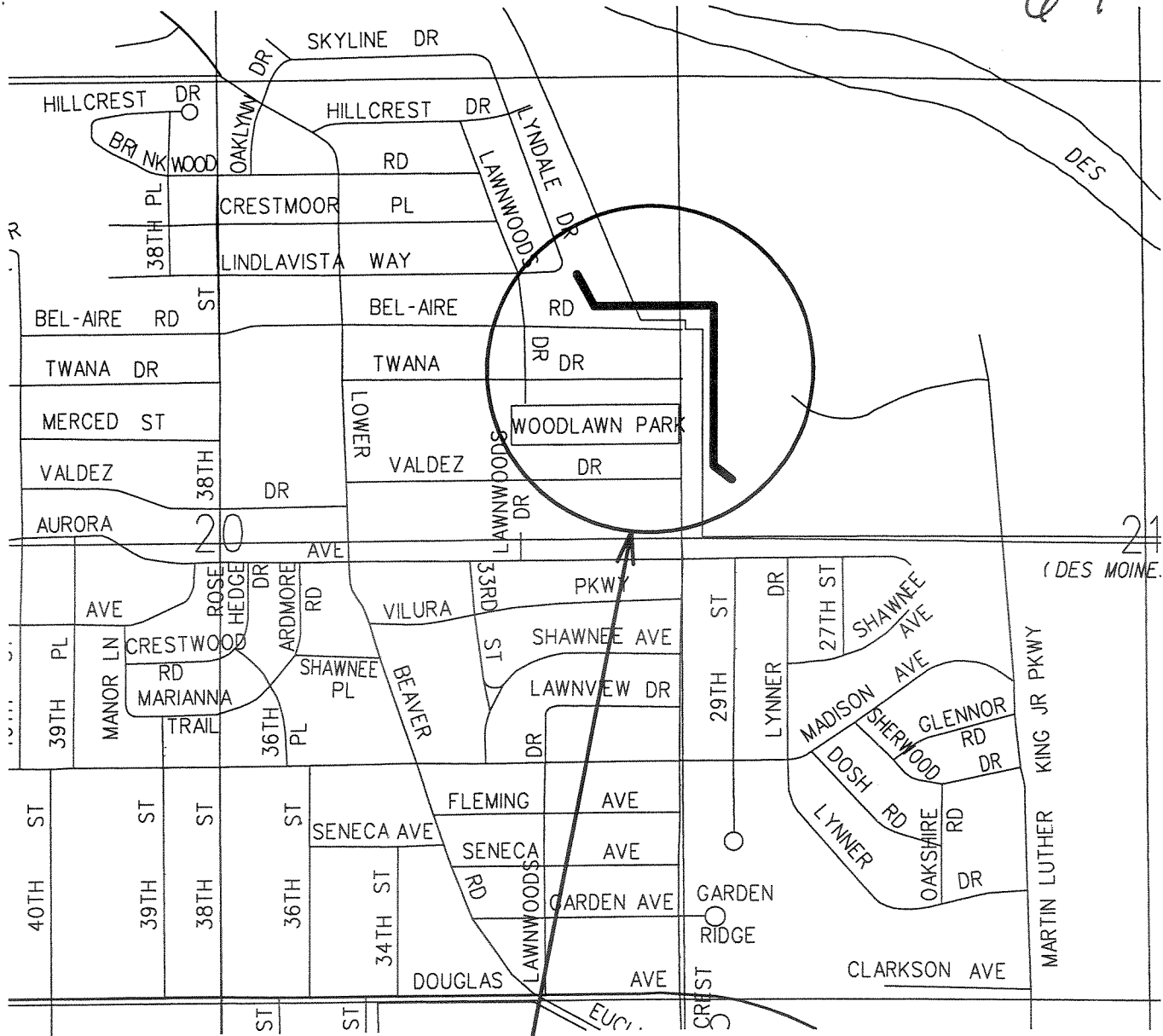

**PROJECT
LOCATION**

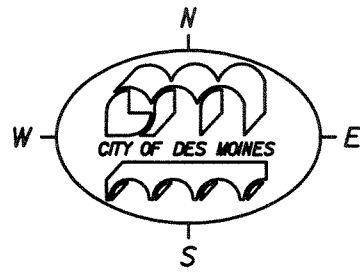

**TWANA/BEL-AIRE STORM
SEWER IMPROVEMENTS**

ACTIVITY I.D. 08-2006-003

T:\Eng\Design\08\2006\003\Drawings\Loc_Map\LOC_MAP.DGN 07-JUN-2006 08:59

CONSTRUCTION ESTIMATE

6 F

DEPARTMENT OF ENGINEERING
CITY OF DES MOINES, IOWA

ACTIVITY ID: 08-2006-003

DATE: 06/26/06

PROJECT: Twana/Bel-Aire Storm Sewer Improvements

NO.	DESCRIPTION	ESTIMATED UNITS			AMOUNT
		UNIT	TOTAL	UNIT PRICE	TOTAL
1	* Mobilization	LS	1	\$50,000	\$50,000.00
2	* Silt Fence	LF	3250	\$2	\$6,500.00
3	* Traffic Control	LS	1	\$2,000	\$2,000.00
4	* Clearing and Grubbing	LS	1	\$40,000	\$40,000.00
5	* Core Out Excavation	CY	2000	\$8	\$16,000.00
6	Select Backfill	CY	500	\$10	\$5,000.00
7	* Strip, Salvage, Spread Topsoil	CY	5400	\$4	\$21,600.00
8	* Earthwork	LS	1	\$10,000	\$10,000.00
9	* Excavation, Class 12, Rock	CY	500	\$20	\$10,000.00
10	* Disposal, Rubble	CY	3000	\$20	\$60,000.00
11	* Pavement Removal	SY	251	\$7	\$1,757.00
12	Drill and Dowel Pavement	LF	17	\$5	\$85.00
13	Subgrade Preparation	SY	11	\$3	\$33.00
14	Pavement, Roadway, Non-Reinforced PCC, Class C, 7"	SY	7	\$45	\$315.00
15	Pavement, 6" PCC	SY	227	\$40	\$9,080.00
16	Sidewalk, 4" PCC	SF	156	\$4	\$624.00
17	* Granular Surfacing, Temporary	TON	100	\$30	\$3,000.00
18	* Removal, Storm Sewer Pipe	LF	223	\$15	\$3,345.00
19	* Removal, Storm Sewer Structure	EA	1	\$750	\$750.00
20	Sewer Abandonment	LF	37	\$50	\$1,850.00
21	Trench Bottom Stabilization	CY	1500	\$25	\$37,500.00
22	Granular Backfill	CY	2000	\$15	\$30,000.00
23	Sewer, Storm, 12" RCP, Class III	LF	6	\$25	\$150.00
24	Sewer, Storm, 15" RCP, Class III	LF	30	\$35	\$1,050.00

6 F

NO.	DESCRIPTION	ESTIMATED UNITS			AMOUNT
		UNIT	TOTAL	UNIT PRICE	TOTAL
25	Sewer, Storm, 36" RCP, Class III	LF	6	\$75	\$450.00
26	Sewer, Storm, 54" RCP, Class III	LF	308	\$200	\$61,600.00
27	Sewer, Storm, 54" RCP, Class IV	LF	254	\$280	\$71,120.00
28	Sewer, Storm, 54" RCP, Class V	LF	1148	\$475	\$545,300.00
29	Sewer, Storm, 8' x 6' RCB, Precast	LF	56	\$475	\$26,600.00
30	Manhole, Storm, Type M-D	EA	3	\$20,000	\$60,000.00
31	Manhole, Storm, Type M-D, Special	EA	4	\$30,000	\$120,000.00
32	Manhole, Storm, Rehabilitation	EA	1	\$1,000	\$1,000.00
33	Intake, Type M-I	EA	1	\$4,000	\$4,000.00
34	Flared End Section, 36" RCP	EA	1	\$2,000	\$2,000.00
35	Flared End Section, 54" RCP	EA	1	\$3,000	\$3,000.00
36	Sloped End Section, 8' x 6' RCB, Precast, 3:1 Slope, 30° Skew	EA	1	\$10,000	\$10,000.00
37	Sloped End Section, 8' x 6' RCB, Precast, 2:1 Slope	EA	1	\$5,500	\$5,500.00
38	Sanitary Sewer Service Adjustment	LF	90	\$75	\$6,750.00
39	Water Service Adjustment	LF	90	\$35	\$3,150.00
40	Sewer Pipe Supports	EA	5	\$500	\$2,500.00
41	* Rip Rap, Class E	TON	1350	\$40	\$54,000.00
42	* Temporary Erosion Mat	SY	130	\$2	\$260.00
43	* Fence Removal	LF	140	\$4	\$560.00
44	Fence, Chain Link, 4'	LF	58	\$6	\$348.00
45	Fence, Wood, 6'	LF	82	\$15	\$1,230.00
46	* Temporary Fence	LF	41	\$3	\$123.00
47	* Sodding	SQ	207	\$35	\$7,245.00
48	* Seeding, Fertilization - Lawn Mixture	AC	1.32	\$2,000	\$2,640.00
49	* Temporary Seeding	AC	3.62	\$500	\$1,810.00
50	* Mulching	AC	9.88	\$750	\$7,410.00
51	* Erosion Control	LS	1	\$5,000	\$5,000.00
52	* Project Sign "Large"	EA	1	\$1,000	\$1,000.00

CF

NO.	DESCRIPTION	ESTIMATED UNITS			AMOUNT
		UNIT	TOTAL	UNIT PRICE	TOTAL
53 *	Construction Survey	LS	1	\$10,000	\$10,000.00

Prepared By: ADAM BULLERMAN

Checked By: Matthew Becher

TOTAL CONSTRUCTION COST	\$1,325,235.00
--------------------------------	-----------------------

* Item does not have to be included in 4-year maintenance bond, but shall be covered by a 1-year maintenance bond.

* Estimate Total= \$315,000.00