

DATE June 9, 2008

ORDERING CONSTRUCTION OF  
FLEUR DRIVE PLANTERS AT GRAY'S LAKE PARK  
AND FIXING A DATE FOR RECEIVING OF BIDS ON JUNE 17, 2008  
AND PUBLIC HEARING ON JULY 14, 2008  
ENGINEER'S ESTIMATE IS \$317,776.00

WHEREAS, this Council deems it advisable and necessary to construct the below referenced improvement, all in accordance with the plans and specifications, and has caused to be prepared plans, specifications, and form of contract, together with estimate of cost, which are now on file in the City Engineer's Office, 2nd Floor, City Hall, 400 Robert D. Ray Drive, Des Moines, Iowa 50309-1891, for public inspection for the construction of said improvements, and said plans, specifications and form of contract are deemed suitable for the making of said improvement, for which the State of Iowa Department of Transportation (IDOT) and the City of Des Moines, (CITY) have an agreement, previously approved by this Council, under which the IDOT has agreed to advertise, receive, open and tabulate sealed bids, and

WHEREAS, before said plans, specifications, form of contract, and estimated cost of the improvement may be approved, and contract for the construction of the improvement entered into, it is necessary to hold a public hearing.

BE IT RESOLVED BY THE CITY COUNCIL OF THE CITY OF DES MOINES, IOWA: That the attached communication recommending construction of the following improvement and the method of financing; and also including the recommendation of the Des Moines City Engineer, as the Jurisdictional Engineer, submitting plans, specifications, form of contract documents, and Jurisdictional Engineer's estimate of cost for the construction of the following improvement:

Fleur Drive Planters at Gray's Lake Park, 04-2008-003

STP-E-1945(737)--8V-77

The improvement includes construction of median planters in the existing median which consist of cast-in-place or precast curbs and precast piers, colored concrete edging, sod, and other incidental items; in accordance with the contract documents, including Plans File Nos. 490-102/115, on Fleur Drive from George Flagg Parkway to the north entrance to Gray's Lake Park, Des Moines, Iowa

be and the same are hereby approved and accepted. The estimated construction cost for said improvement is \$317,776.00. The proposed plans, specifications, and form of contract documents are available for public inspection in the City Engineer's Office.

BE IT FURTHER RESOLVED: That this Council hereby determines that it is necessary and advisable to construct said improvement in the manner set forth in the plans, specifications, and form of contract documents submitted by the Jurisdictional Engineer; and that payment for the cost of said improvement shall be paid from from the funding source identified below.

★ **Roll Call Number**

Agenda Item Number

6B

DATE June 9, 2008

BE IT FURTHER RESOLVED: That a public hearing on said plans, specifications, form of contract documents, and Jurisdictional Engineer's estimate of construction cost for said improvement be held in the City Council Chambers, 2nd Floor, City Hall, 400 Robert D. Ray Drive, Des Moines, Iowa, at 5:00 p.m. on July 14, 2008, at which time this Council will consider any objections offered thereto or to the making of said improvement.

BE IT FURTHER RESOLVED: That proposals will be received by the Iowa Department of Transportation, for the construction of said improvements, and the taking of bids in the manner required by law. Proposals received will be opened and tabulated by the Iowa Department of Transportation on June 17, 2008, after which the bids together with a report and recommendation of the Chief Civil Engineer, will be presented to City Council at its next meeting for action thereon.

BE IT FURTHER RESOLVED: That an appropriate Notice to Bidders and Notice of Public Hearing for said improvement be published in the Des Moines Register as provided and directed by Chapter 26 and/or 314, Code of Iowa.

(City Council Communication Number 08-348 attached.)

Moved by \_\_\_\_\_ to adopt.

FORM APPROVED:

FUNDS AVAILABLE

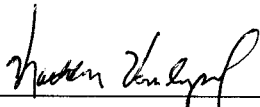
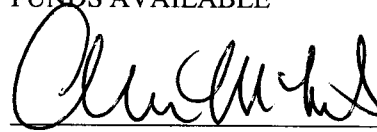
Kathleen Vanderpool  
Deputy City Attorney

Allen McKinley  
Des Moines Finance Director

Funding Source: 2008-2009 CIP, Page Parks-10, Fleur Drive Planters, PKS170, Being: \$254,220.80 in FHWA Surface Transportation (STP) Funds (80% of the total cost of eligible construction items not to exceed \$300,000) and \$63,555.20 in G. O. Bonds

COUNCIL ACTION	YEAS	NAYS	PASS	ABSENT
COWNIE				
COLEMAN				
HENSLEY				
KIERNAN				
MAHAFFEY				
MEYER				
VLISSIS				
TOTAL				

MOTION CARRIED

APPROVED

\_\_\_\_\_  
Mayor

**CERTIFICATE**

I, DIANE RAUH, City Clerk of said City hereby certify that at a meeting of the City Council of said City of Des Moines, held on the above date, among other proceedings the above was adopted.

IN WITNESS WHEREOF, I have hereunto set my hand and affixed my seal the day and year first above written.

\_\_\_\_\_  
City Clerk

6 B

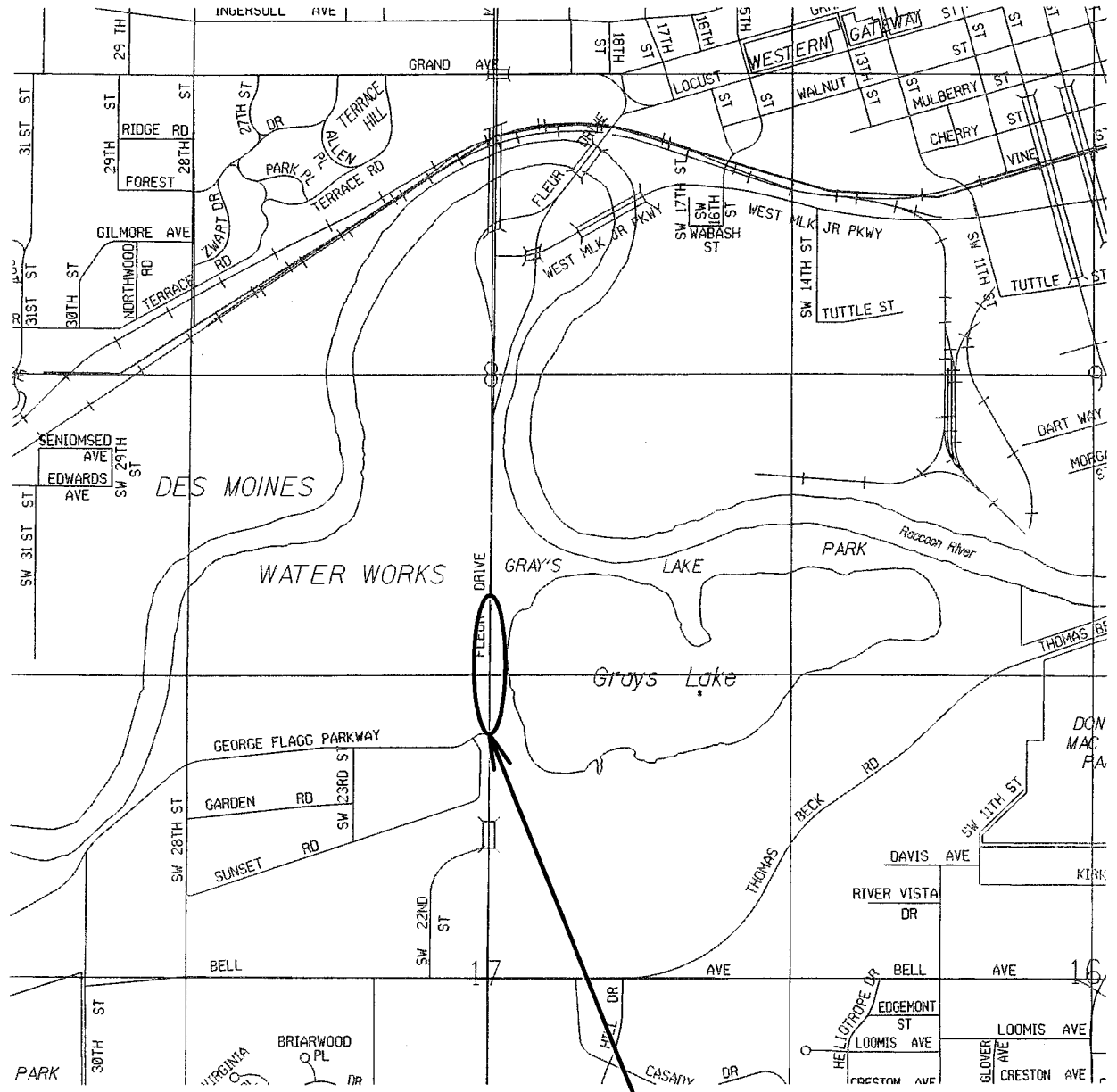

**PROJECT  
LOCATION**

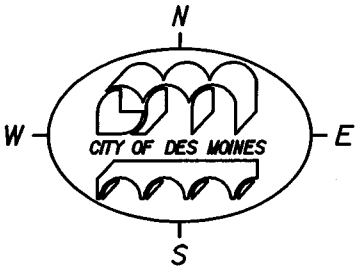

**FLEUR DRIVE PLANTERS  
AT GRAY'S LAKE  
ACTIVITY I.D. 04-2008-003**

6B

**CONSTRUCTION ESTIMATE**

DEPARTMENT OF ENGINEERING  
CITY OF DES MOINES, IOWA

ACTIVITY ID 04-2008-003  
PROJ NO.: STP-E-1945(737)-8V-77

**PROJECT: FLEUR DRIVE PLANTERS AT GRAY'S LAKE PARK**

DATE: 5/29/08

NO.	ITEM CODE	DESCRIPTION	ESTIMATED UNITS			AMOUNT
			UNIT	TOTAL	UNIT PRICE	TOTAL
0010	2101-0850002	CLEARING AND GRUBBING	UNIT	54.400	\$50.00	\$2,720.00
0020	2102-2710070	EXCAVATION, CLASS 10, ROADWAY AND BORROW	CY	430.000	\$20.00	\$8,600.00
0030	2110-3825010	GRANULAR MATERIAL	TON	180.000	\$40.00	\$7,200.00
0040	2401-7207010	REMOVAL OF CONCRETE	SY	210.000	\$25.00	\$5,250.00
0050	2402-2720000	EXCAVATION, CLASS 20	CY	260.000	\$50.00	\$13,000.00
0060	2403-0100000	STRUCTURAL CONCRETE (MISCELLANEOUS)	CY	142.400	\$600.00	\$85,440.00
0070	2404-7775000	REINFORCING STEEL	LB	3504.000	\$1.50	\$5,256.00
0080	2528-8445110	TRAFFIC CONTROL	LS	1.000	\$20,000.00	\$20,000.00
0090	2533-4980005	MOBILIZATION	LS	1.000	\$30,000.00	\$30,000.00
0100	2599-9999005	COLORED CONCRETE CORNER PIER	EACH	8.000	\$1,000.00	\$8,000.00
0110	2599-9999005	COLORED CONCRETE IN-LINE PIER	EACH	12.000	\$1,000.00	\$12,000.00
0120	2599-9999005	REMOVAL OF EXISTING PLANTERS	EACH	12.000	\$200.00	\$2,400.00
0130	2599-9999009	COLORED CONCRETE PLANTER CURB	LF	800.000	\$75.00	\$60,000.00
0140	2599-9999018	4" P.C.C. PAVER SETTING BASE	SY	46.000	\$60.00	\$2,760.00
0150	2599-9999018	5" P.C.C. COLORED CONCRETE PLANTER BAND	SY	450.000	\$80.00	\$36,000.00
0160	2599-9999018	BITUMINOUS SETTING BED	SY	46.000	\$75.00	\$3,450.00
0170	2599-9999014	CITY OF DES MOINES ANTIQUE CLAY STREET PAVERS	SY	46.000	\$200.00	\$9,200.00
0180	2601-2639010	SODDING	SQ	130.000	\$50.00	\$6,500.00
<b>TOTAL CONSTRUCTION COST</b>						\$317,776.00

Prepared By: David Kamp  
Checked By: Gary Hlavka